

| ΚΟΜΜΕΣ | X | Y | ΠΛΕΥΡΕΣ | Ε= 40033,32 μ² |
|--------|------------|-------------|---------|----------------|
| 133 | 376364,521 | 4092676,818 | 18,88 | |
| 134 | 376379,455 | 4092688,973 | 21,39 | |
| 135 | 376398,039 | 4092698,923 | 19,11 | |
| 136 | 376420,279 | 4092715,587 | 8,93 | |
| 137 | 376424,108 | 4092723,658 | 13,3 | |
| 138 | 376432,973 | 4092733,978 | 11,65 | |
| 139 | 376426,696 | 4092740,003 | 11,77 | |
| 140 | 376427,226 | 4092755,323 | 13,5 | |
| 141 | 376490,281 | 4092758,78 | 11,47 | |
| 142 | 376501,603 | 4092760,532 | 22,29 | |
| 143 | 376528,803 | 4092766,999 | 22,72 | |
| 144 | 376579,401 | 4092769,007 | 24,28 | |
| 147 | 376601,548 | 4092793,454 | 22,96 | |
| 148 | 376601,548 | 4092793,454 | 22,96 | |
| 149 | 376650,313 | 4092795,635 | 25,93 | |
| 150 | 376650,313 | 4092795,635 | 25,93 | |
| 151 | 376687,851 | 4092793,001 | 23,94 | |
| 152 | 376687,851 | 4092793,001 | 23,94 | |
| 153 | 376713,483 | 4092779,423 | 17,73 | |
| 154 | 376713,483 | 4092779,423 | 17,73 | |
| 155 | 376725,093 | 4092784,039 | 56,76 | |
| 156 | 376649,259 | 4092793,009 | 11,24 | |
| 157 | 376631,308 | 4092793,009 | 33,54 | |
| 78 | 376601,308 | 4092793,009 | 23,6 | |
| 79 | 376588,37 | 4092794,904 | 10 | |
| 80 | 376579,386 | 4092688,882 | 13,36 | |
| 81 | 376579,386 | 4092688,882 | 13,36 | |
| 82 | 376573,471 | 4092693,885 | 44,27 | |
| 83 | 376531,502 | 4092643,795 | 13,45 | |
| 84 | 376531,502 | 4092643,795 | 13,45 | |
| 85 | 376521,521 | 4092634,773 | 13,31 | |
| 86 | 376488,762 | 4092633,007 | 11,34 | |
| 87 | 376488,762 | 4092633,007 | 11,34 | |
| 88 | 376469,541 | 4092603,894 | 16,84 | |
| 89 | 376469,541 | 4092603,894 | 16,84 | |
| 90 | 376472,816 | 4092590,569 | 13,33 | |
| 91 | 376472,816 | 4092590,569 | 13,33 | |
| 92 | 376471,82 | 4092511,676 | 20,24 | |
| 93 | 376471,82 | 4092511,676 | 20,24 | |
| 94 | 376472,816 | 4092491,594 | 9,05 | |
| 95 | 376472,816 | 4092491,594 | 9,05 | |
| 96 | 376468,289 | 4092481,861 | 19,45 | |
| 97 | 376466,275 | 4092488,239 | 29,47 | |
| 98 | 376436,7 | 4092516,339 | 9,38 | |
| 99 | 376436,7 | 4092516,339 | 9,38 | |
| 100 | 376423,462 | 4092540,202 | 24,24 | |
| 101 | 376423,462 | 4092540,202 | 24,24 | |
| 102 | 376423,462 | 4092540,202 | 24,24 | |
| 103 | 376394,243 | 4092486,111 | 16,88 | |
| 104 | 376394,243 | 4092486,111 | 16,88 | |
| 105 | 376393,372 | 4092485,214 | 14,84 | |
| 106 | 376393,372 | 4092485,214 | 14,84 | |
| 107 | 376357,32 | 4092493,562 | 28,6 | |
| 108 | 376357,32 | 4092493,562 | 28,6 | |
| 109 | 376354,894 | 4092512,439 | 15,45 | |
| 110 | 376354,894 | 4092512,439 | 15,45 | |
| 111 | 376393,436 | 4092500,358 | 7,25 | |
| 112 | 376393,436 | 4092500,358 | 7,25 | |
| 113 | 376388,859 | 4092488,387 | 9,14 | |
| 114 | 376388,859 | 4092488,387 | 9,14 | |
| 115 | 376277,788 | 4092490,539 | 7,58 | |
| 116 | 376280,717 | 4092497,528 | 18,79 | |
| 117 | 376288,989 | 4092514,398 | 8,7 | |
| 118 | 376293,041 | 4092522,003 | 11,02 | |
| 119 | 376305,298 | 4092559,133 | 14,8 | |
| 120 | 376312,945 | 4092571,806 | 10,11 | |
| 121 | 376319,018 | 4092579,888 | 9,62 | |
| 122 | 376329,522 | 4092584,599 | 21,13 | |
| 123 | 376333,472 | 4092572,89 | 22,72 | |
| 124 | 376333,472 | 4092572,89 | 22,72 | |
| 125 | 376373,724 | 4092562,6 | 6,57 | |
| 126 | 376380,295 | 4092562,6 | 10,11 | |
| 127 | 376388,975 | 4092579,79 | 26,24 | |
| 128 | 376427,571 | 4092611,571 | 15,26 | |
| 129 | 376427,571 | 4092611,571 | 15,26 | |
| 130 | 376414,553 | 4092619,543 | 42,72 | |
| 131 | 376378,504 | 4092642,466 | 33,96 | |
| 132 | 376378,504 | 4092642,466 | 33,96 | |

| ΚΟΜΜΕΣ | X | Y | ΠΛΕΥΡΕΣ | Ε= 23152,72 μ² |
|--------|------------|-------------|---------|----------------|
| 1 | 376737,538 | 4093107,238 | 8,49 | |
| 2 | 376743,545 | 4093113,27 | 9,22 | |
| 3 | 376752,707 | 4093114,308 | 9,59 | |
| 4 | 376757,569 | 4093102,301 | 59,03 | |
| 5 | 376757,569 | 4093102,301 | 59,03 | |
| 6 | 376765,696 | 4093031,296 | 23,41 | |
| 7 | 376765,696 | 4093031,296 | 23,41 | |
| 8 | 376768,723 | 4093001,314 | 19,93 | |
| 9 | 376768,723 | 4093001,314 | 19,93 | |
| 10 | 376768,723 | 4092991,531 | 12,29 | |
| 11 | 376768,723 | 4092991,531 | 12,29 | |
| 12 | 376768,723 | 4092980,185 | 11,37 | |
| 13 | 376768,723 | 4092980,185 | 11,37 | |
| 14 | 376768,723 | 4092980,185 | 11,37 | |
| 15 | 376768,723 | 4092980,185 | 11,37 | |
| 16 | 376768,723 | 4092980,185 | 11,37 | |
| 17 | 376768,723 | 4092980,185 | 11,37 | |
| 18 | 376768,723 | 4092980,185 | 11,37 | |
| 19 | 376768,723 | 4092980,185 | 11,37 | |
| 20 | 376768,723 | 4092980,185 | 11,37 | |
| 21 | 376768,723 | 4092980,185 | 11,37 | |
| 22 | 376768,723 | 4092980,185 | 11,37 | |
| 23 | 376768,723 | 4092980,185 | 11,37 | |
| 24 | 376768,723 | 4092980,185 | 11,37 | |
| 25 | 376768,723 | 4092980,185 | 11,37 | |
| 26 | 376768,723 | 4092980,185 | 11,37 | |
| 27 | 376768,723 | 4092980,185 | 11,37 | |
| 28 | 376768,723 | 4092980,185 | 11,37 | |
| 29 | 376768,723 | 4092980,185 | 11,37 | |
| 30 | 376768,723 | 4092980,185 | 11,37 | |
| 31 | 376768,723 | 4092980,185 | 11,37 | |
| 32 | 376768,723 | 4092980,185 | 11,37 | |
| 33 | 376768,723 | 4092980,185 | 11,37 | |
| 34 | 376768,723 | 4092980,185 | 11,37 | |
| 35 | 376768,723 | 4092980,185 | 11,37 | |
| 36 | 376768,723 | 4092980,185 | 11,37 | |
| 37 | 376768,723 | 4092980,185 | 11,37 | |
| 38 | 376768,723 | 4092980,185 | 11,37 | |
| 39 | 376768,723 | 4092980,185 | 11,37 | |
| 40 | 376768,723 | 4092980,185 | 11,37 | |
| 41 | 376768,723 | 4092980,185 | 11,37 | |
| 42 | 376768,723 | 4092980,185 | 11,37 | |
| 43 | 376768,723 | 4092980,185 | 11,37 | |
| 44 | 376768,723 | 4092980,185 | 11,37 | |
| 45 | 376768,723 | 4092980,185 | 11,37 | |
| 46 | 376768,723 | 4092980,185 | 11,37 | |
| 47 | 376768,723 | 4092980,185 | 11,37 | |
| 48 | 376768,723 | 4092980,185 | 11,37 | |
| 49 | 376768,723 | 4092980,185 | 11,37 | |
| 50 | 376768,723 | 4092980,185 | 11,37 | |

| ΚΟΜΜΕΣ | X | Y | ΠΛΕΥΡΕΣ | Ε= 8278,88 μ² |
|--------|------------|-------------|---------|---------------|
| 67 | 376782,016 | 4093004,324 | 1,49 | |
| 68 | 376783,497 | 4093004,435 | 12,62 | |
| 69 | 376795,969 | 4093006,534 | 36,87 | |
| 70 | 376800,111 | 4092940,435 | 16,44 | |
| 71 | 376801,141 | 4092926,451 | 28,23 | |
| 72 | 376801,141 | 4092926,451 | 28,23 | |
| 73 | 376802,287 | 4092900,474 | 24,24 | |
| 74 | 376802,287 | 4092900,474 | 24,24 | |
| 75 | 376802,287 | 4092884,446 | 42,54 | |
| 76 | 376802,287 | 4092884,446 | 42,54 | |
| 77 | 376802,287 | 4092884,446 | 42,54 | |
| 78 | 376802,287 | 4092884,446 | 42,54 | |
| 79 | 376802,287 | 4092884,446 | 42,54 | |
| 80 | 376802,287 | 4092884,446 | 42,54 | |
| 81 | 376802,287 | 4092884,446 | 42,54 | |
| 82 | 376802,287 | 4092884,446 | 42,54 | |
| 83 | 376802,287 | 4092884,446 | 42,54 | |
| 84 | 376802,287 | 4092884,446 | 42,54 | |
| 85 | 376802,287 | 4092884,446 | 42,54 | |
| 86 | 376802,287 | 4092884,446 | 42,54 | |
| 87 | 376802,287 | 4092884,446 | 42,54 | |
| 88 | 376802,287 | 4092884,446 | 42,54 | |
| 89 | 376802,287 | 4092884,446 | 42,54 | |
| 90 | 376802,287 | 4092884,446 | 42,54 | |
| 91 | 376802,287 | 4092884,446 | 42,54 | |
| 92 | 376802,287 | 4092884,446 | 42,54 | |
| 93 | 376802,287 | 4092884,446 | 42,54 | |
| 94 | 376802,287 | 4092884,446 | 42,54 | |
| 95 | 376802,287 | 4092884,446 | 42,54 | |
| 96 | 376802,287 | 4092884,446 | 42,54 | |
| 97 | 376802,287 | 4092884,446 | 42,54 | |
| 98 | 376802,287 | 4092884,446 | 42,54 | |
| 99 | 376802,287 | 4092884,446 | 42,54 | |
| 100 | 376802,287 | 4092884,446 | 42,54 | |

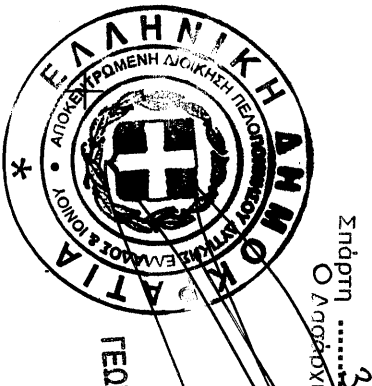

ΕΛΛΗΝΙΚΗ ΔΗΜΟΚΡΑΤΙΑ
ΥΠΟΥΡΓΕΙΟ ΠΕΡΙΒΑΛΛΟΝΤΟΣ, ΟΥΡΒΑΝΙΣΜΟΥ ΚΑΙ ΚΑΤΑΣΤΡΟΦΩΝ
ΓΕΩΠΛΗΘΕΣ ΤΕΧΝΟΛΟΓΙΑΣ
ΔΙΕΥΘΥΝΣΗ ΓΕΩΜΕΤΡΙΚΩΝ ΕΡΓΩΝ
Οργανισμός Σχεδίων
Σχέδιο 2015...

Συμπρω 3-7-2015
Ο Ευθύνης Σωφ. Αρτοποιίου
ΓΕΩΠΛΗΘΕΣ ΤΕΧΝΟΛΟΓΙΑΣ
ΔΙΕΥΘΥΝΣΗ ΓΕΩΜΕΤΡΙΚΩΝ ΕΡΓΩΝ

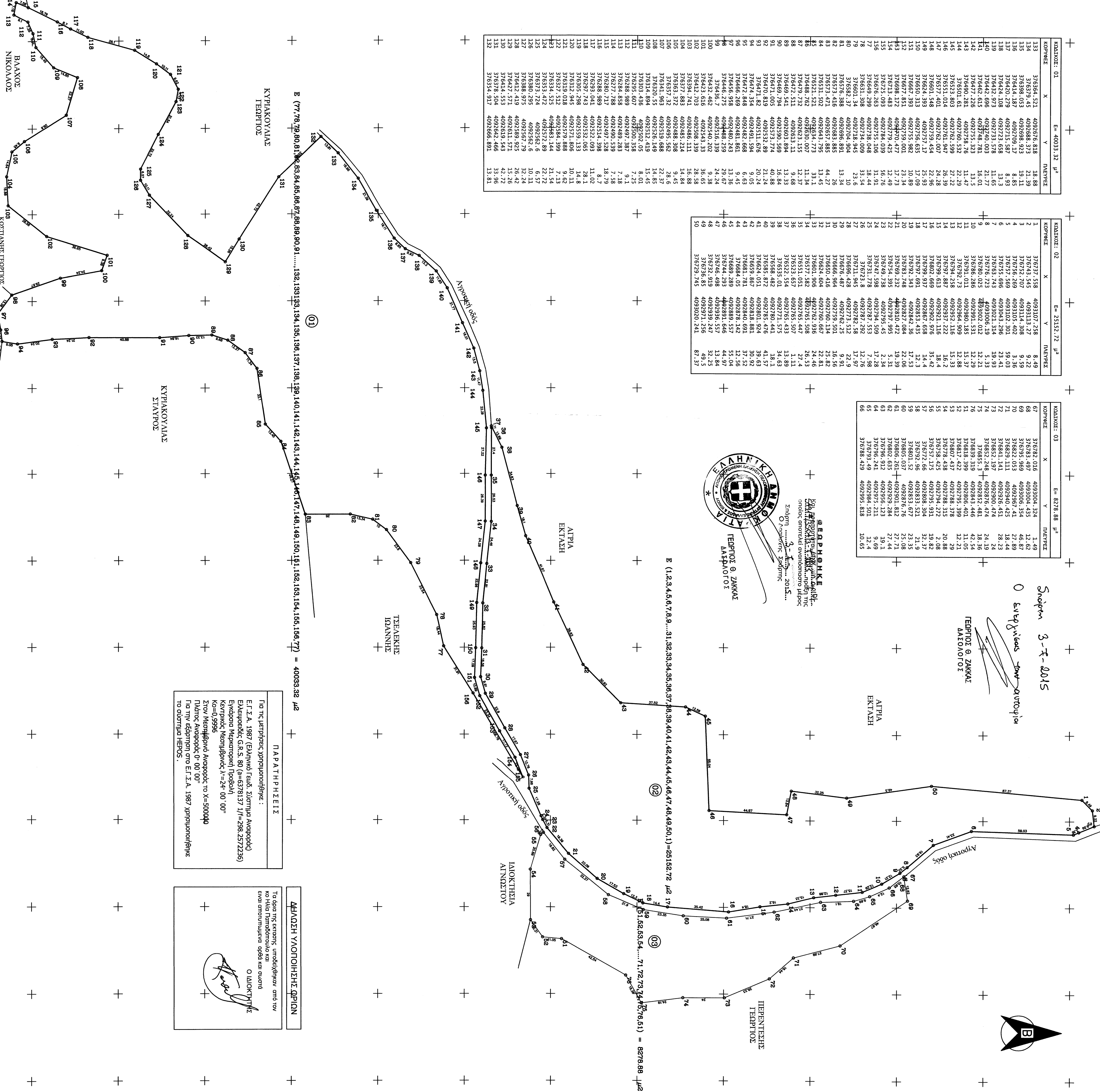

Ε (77.78.90.81.98.83.84.85.86.87.88.89.90.91.....132.133.139.134.135.136.137.138.139.140.141.142.143.144.145.146.147.148.149.150.151.152.153.154.155.156.77) = 40033,32 μ²

Ε (1.2.3.4.5.6.7.8.9...31.32.33.34.35.36.37.38.39.40.41.42.43.44.45.46.47.48.49.50.1)=25152,72 μ²

ΠΑΡΑΤΗΡΗΣΕΙΣ
Για τις μετρήσεις χρησιμοποιήθηκε :
Ε.Γ.Α. 1987 (Ελληνικό Έως Σίστημα Αναφοράς)
Εγκυκλιολ. Γ.Κ.Σ. 80 (α=6378137 1/π=298,2572236)
Κέντρο της Μεταβολής Προβολής
Κο=0,9996
Ζών Αναφοράς το Χ=500000
Ζών Αναφοράς το Υ=00' 00"
Για την Εξάφηση στο Ε.Γ.Α. 1987 χρησιμοποιήθηκε
το σύστημα HEPOS.

ΑΒΑΘΗΣ ΥΠΟΤΟΜΗΤΗΣ ΔΡΑΚΙΝ
Το όλο της έκτασης υποδείχθηκε από τον
ενα απορριμμένο σχέδιο και αυτός
Ο ΔΙΟΚΤΗΣ

| | |
|--|--|
| | |
| <p>Εργοδότης : ΠΑΠΑΔΟΠΟΥΛΟΣ ΗΛΙΑΣ</p> <p>Εργο : ΤΟΠΟΓΡΑΦΙΚΟ ΔΙΑΓΡΑΜΜΑ</p> <p>Θέση έργου : "ΚΑΡΑΜΙΧΑΣ", Τ.Δ. Αγ. Αναργύρων , Δ.Ε. Θεσσαλίων Δήμου Σιδηρής</p> <p>Μελετητής : ΜΑΧΑΙΡΑΣ ΠΑΝΑΓΙΩΤΗΣ</p> <p>Θέμα σχεδίου : Τοπογραφικό Διάγραμμα</p> <p>Ημερομηνία : Μάιος 2014</p> <p>Κλίμακα 1:1.000</p> <p>Ο ΣΥΝΤΑΞΑΣ</p> <p>ΘΕΩΡΗΘΗΚΕ</p> | <p>ΔΑΣΟΤΕΧΝΙΚΟ ΓΡΑΦΕΙΟ ΜΑΧΑΙΡΑΣ ΠΑΝΑΓΙΩΤΗΣ Δασολόγος - Περιβαλλοντολόγος Α.Π.Θ. Κ. Παλαίουδου 34, Σιδηρή Τηλ. 27310-28828, fax 27310-28827 Κιν. 6973-775252 e-mail : pmaxi@otenet.gr</p> |