

ΥΠΕΥΘΥΝΗ ΔΗΛΩΣΗ

Ο κάτω υπογεγραμμένος Αργύριος Σκοπελιτής, Δημόσιος Πολιτικός Μηχανικός δηλώνω υπεύθυνα βάσει του Ν. 651/77 ότι:
Α. Το προαναφερθέν γήπεδο (12,3x4,6... 112,1x115,1) ιδιοκτησίας Δ. Λαζαρίδη & Μ. Γαλαριώτη στο οποίο βρίσκεται επί θέση "ΜΑΡΜΑΡΟΥ" της περιφέρειας Περιφέρειας Πελοποννήσου, του Δήμου Λακωνίας, έχει πλυστικές διαστάσεις και οριζόντιες διαστάσεις ως αναγράφονται, επιφάνεια εμβαδού Ε=29.046,47μ² και είναι όριο και οικοδομημένο σύμφωνα με τις ισχύουσες διατάξεις, με την επιφύλαξη της πράξης χαρακτηρισμού του άρθρου 14 του Ν. 998/79 από τη Διεύθυνση Δομών και της χορήγησης έγκρισης για οδία οικοδομής από την αρμόδια Εφορεία Αρχαιοτήτων σύμφωνα με το Ν. 3026/02.

Β. Το παραπάνω γήπεδο δε βρίσκεται σε οικόπεδο, σε αγράβια, σε ζώνη προστασίας, σε δρόμο και σε δημόσιο κτίσμα με την επιφύλαξη της πράξης χαρακτηρισμού του άρθρου 14 του Ν. 998/79 από τη Διεύθυνση Δομών. Το γήπεδο βρίσκεται στον κτηματολόγιο εκκαθαρωθέν κτήμα ΠΥΡΓΙΟΥ ΠΕΡΑΜΑΤΟΣ-ΠΕΡΑΜΑ ΕΥΡΕΙΑΚΗ (ΥΠΟΔ/ΑΡΧ/Α/043/8236/48111-2-92, ΘΕΚ 164/Β/10-9-92, Δελτίο αρχαίων οικοπέδων και αρχαίας πόλης ΙΕΡΑ).

Γ. Το παραπάνω γήπεδο απέχει σε ευθεία νοτιο-γραμμική από τα όρια του οικισμού Μαρμαρού 910μ περίπου, από ασφαλοποιημένη οδό 400μ περίπου και από δρόμο 410μ περίπου.

Δ. Το σκίτσο δεν εμπνέει στις διατάξεις του Ν. 1337/1983 περί εισαγών σε γη και σε χρήση.
Ε. Το γήπεδο εμπνέει σε περιοχή κατοικίας Εθνικού Κτηματολογίου με ΓΚΕΚ 330671303017.

Μαρίληνη Λι, 05/10/05
Υπεύθυνα Δήλωση

ΑΡΓΥΡΙΟΣ Σ. ΣΚΟΠΕΛΙΤΗΣ
ΔΙΠΛ. ΠΟΛΙΤΙΚΟΣ ΜΗΧΑΝΙΚΟΣ Α.Π.Θ.
ΜΣ.Ε.Μ.Π. ΔΕΛΤΑ ΔΙΑΓΡΑΜΜΟΣ
ΜΕΛΟΣ Τ.Ε.Ε. ΑΡΧ. ΜΗΤΡΟΥ 1280/4
ΝΑ. ΒΕΝΕΖΗ 24 - ΜΥΤΙΛΗΝΗ ΤΗΛ:2251103033
Α.Φ.Μ. 132929627 - Α.Ο.Υ. ΜΥΤΙΛΗΝΗΣ

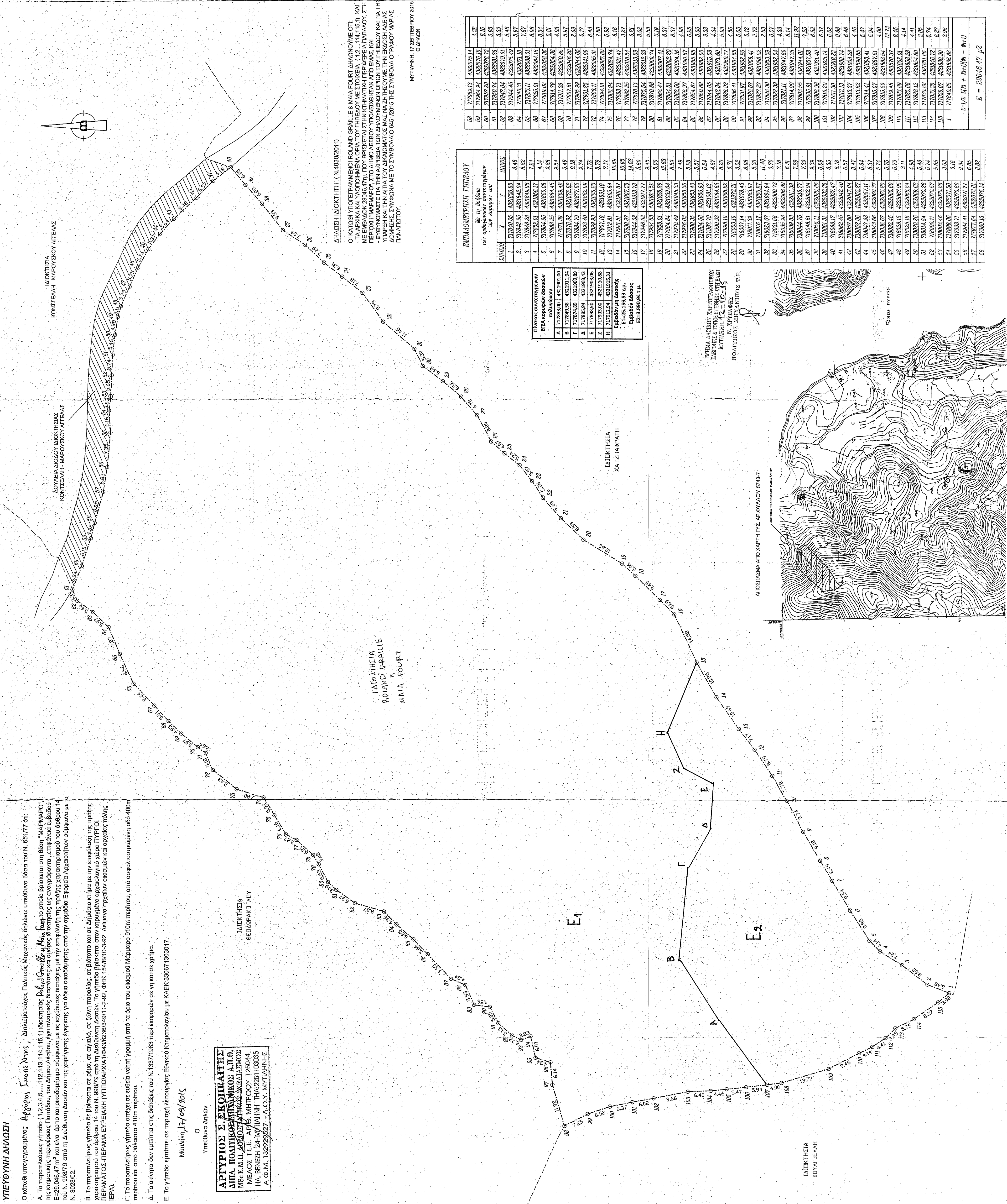

ΔΙΑΚΤΗΣΙΑ ΚΑΤΕΧΕΙΑ ΚΑΤΖΗΦΑΡΑΤΗ

ΔΙΑΚΤΗΣΙΑ ΒΕΤΙΑΓΡΑΦΛΟΥ

ΔΙΑΚΤΗΣΙΑ ΚΑΤΕΧΕΙΑ ΚΑΤΖΗΦΑΡΑΤΗ

ΔΙΑΚΤΗΣΙΑ ΒΕΤΙΑΓΡΑΦΛΟΥ

ΔΙΑΚΤΗΣΙΑ ΚΑΤΕΧΕΙΑ ΚΑΤΖΗΦΑΡΑΤΗ

ΔΙΑΚΤΗΣΙΑ ΒΕΤΙΑΓΡΑΦΛΟΥ

ΔΙΑΚΤΗΣΙΑ ΚΑΤΕΧΕΙΑ ΚΑΤΖΗΦΑΡΑΤΗ

ΔΙΑΚΤΗΣΙΑ ΒΕΤΙΑΓΡΑΦΛΟΥ

ΔΙΑΚΤΗΣΙΑ ΚΑΤΕΧΕΙΑ ΚΑΤΖΗΦΑΡΑΤΗ

ΔΙΑΚΤΗΣΙΑ ΒΕΤΙΑΓΡΑΦΛΟΥ

ΔΙΑΚΤΗΣΙΑ ΚΑΤΕΧΕΙΑ ΚΑΤΖΗΦΑΡΑΤΗ

ΔΙΑΚΤΗΣΙΑ ΒΕΤΙΑΓΡΑΦΛΟΥ

ΔΙΑΚΤΗΣΙΑ ΚΑΤΕΧΕΙΑ ΚΑΤΖΗΦΑΡΑΤΗ

ΔΙΑΚΤΗΣΙΑ ΒΕΤΙΑΓΡΑΦΛΟΥ

ΔΙΑΚΤΗΣΙΑ ΚΑΤΕΧΕΙΑ ΚΑΤΖΗΦΑΡΑΤΗ

ΔΙΑΚΤΗΣΙΑ ΒΕΤΙΑΓΡΑΦΛΟΥ

ΔΙΑΚΤΗΣΙΑ ΚΑΤΕΧΕΙΑ ΚΑΤΖΗΦΑΡΑΤΗ

ΔΙΑΚΤΗΣΙΑ ΒΕΤΙΑΓΡΑΦΛΟΥ

ΔΙΑΚΤΗΣΙΑ ΚΑΤΕΧΕΙΑ ΚΑΤΖΗΦΑΡΑΤΗ

ΔΙΑΚΤΗΣΙΑ ΒΕΤΙΑΓΡΑΦΛΟΥ

ΔΙΑΚΤΗΣΙΑ ΚΑΤΕΧΕΙΑ ΚΑΤΖΗΦΑΡΑΤΗ

ΔΙΑΚΤΗΣΙΑ ΒΕΤΙΑΓΡΑΦΛΟΥ

ΔΙΑΚΤΗΣΙΑ ΚΑΤΕΧΕΙΑ ΚΑΤΖΗΦΑΡΑΤΗ

ΔΙΑΚΤΗΣΙΑ ΒΕΤΙΑΓΡΑΦΛΟΥ

ΔΙΑΚΤΗΣΙΑ ΚΑΤΕΧΕΙΑ ΚΑΤΖΗΦΑΡΑΤΗ

ΔΙΑΚΤΗΣΙΑ ΒΕΤΙΑΓΡΑΦΛΟΥ

ΔΙΑΚΤΗΣΙΑ ΚΑΤΕΧΕΙΑ ΚΑΤΖΗΦΑΡΑΤΗ

ΔΙΑΚΤΗΣΙΑ ΒΕΤΙΑΓΡΑΦΛΟΥ

ΔΙΑΚΤΗΣΙΑ ΚΑΤΕΧΕΙΑ ΚΑΤΖΗΦΑΡΑΤΗ

ΔΙΑΚΤΗΣΙΑ ΒΕΤΙΑΓΡΑΦΛΟΥ

ΔΙΑΚΤΗΣΙΑ ΚΑΤΕΧΕΙΑ ΚΑΤΖΗΦΑΡΑΤΗ

ΔΙΑΚΤΗΣΙΑ ΒΕΤΙΑΓΡΑΦΛΟΥ

ΔΙΑΚΤΗΣΙΑ ΚΑΤΕΧΕΙΑ ΚΑΤΖΗΦΑΡΑΤΗ

ΔΙΑΚΤΗΣΙΑ ΒΕΤΙΑΓΡΑΦΛΟΥ

ΔΙΑΚΤΗΣΙΑ ΚΑΤΕΧΕΙΑ ΚΑΤΖΗΦΑΡΑΤΗ

ΔΙΑΚΤΗΣΙΑ ΒΕΤΙΑΓΡΑΦΛΟΥ

ΔΙΑΚΤΗΣΙΑ ΚΑΤΕΧΕΙΑ ΚΑΤΖΗΦΑΡΑΤΗ

ΔΙΑΚΤΗΣΙΑ ΒΕΤΙΑΓΡΑΦΛΟΥ

ΔΙΑΚΤΗΣΙΑ ΚΑΤΕΧΕΙΑ ΚΑΤΖΗΦΑΡΑΤΗ

ΔΙΑΚΤΗΣΙΑ ΒΕΤΙΑΓΡΑΦΛΟΥ

ΔΙΑΚΤΗΣΙΑ ΚΑΤΕΧΕΙΑ ΚΑΤΖΗΦΑΡΑΤΗ

ΔΙΑΚΤΗΣΙΑ ΒΕΤΙΑΓΡΑΦΛΟΥ

ΟΡΟΙ ΔΟΜΗΣΗΣ

ΕΚΤΟΣ ΟΡΙΩΝ ΟΙΚΙΣΜΟΥ (Π.Δ. 24.05.1985 - ΘΕΚ 270Δ 31.05.1985 & Ν. 3212 - ΘΕΚ 308Α / 31.12.2003 )
(για πρόσωπο σε κοινόχρηστο όριο)
Εμβαδόν = 4.000,00μ² - Πρόσωπο = 25,00μ
Εμβαδόν = 4.000,00μ² - Πρόσωπο = 25,00μ
Εμβαδόν = 4.000,00μ² - Πρόσωπο = 25,00μ
Εμβαδόν = 4.000,00μ² - Πρόσωπο = 25,00μ

Διεύθυνση κατά παράβαση:
(για πρόσωπο σε όριο)
Εμβαδόν = 4.000,00μ² - Πρόσωπο = 25,00μ
Εμβαδόν = 4.000,00μ² - Πρόσωπο = 25,00μ
Εμβαδόν = 4.000,00μ² - Πρόσωπο = 25,00μ
Εμβαδόν = 4.000,00μ² - Πρόσωπο = 25,00μ

Συντελεστής Διεύθυνσης:
(για προέκταση με εμβαδόν έως 4.000,00μ²)
Σ.Δ. = 0,20
(για προέκταση με εμβαδόν από 4.000,00μ² έως 8.000,00μ²)
Διεύθυνση = 200μ² + (Εμβαδόν προέκτασης - 4.000,00μ²) x 0,02
(για προέκταση με εμβαδόν από 8.000,00μ² και άνω)
Μέγιστη Διεύθυνση = 400μ

Υψος κτιφίσιας:
(για προέκταση με εμβαδόν έως 4.000,00μ²)
Σ.Δ. = 0,20
(για προέκταση με εμβαδόν από 4.000,00μ² έως 8.000,00μ²)
Διεύθυνση = 200μ² + (Εμβαδόν προέκτασης - 4.000,00μ²) x 0,02
(για προέκταση με εμβαδόν από 8.000,00μ² και άνω)
Μέγιστη Διεύθυνση = 400μ

ΕΡΓΟΣΤΗ: ROLAND GRAILLE & MAIA FOUNT
ΕΡΓΟ: ΑΠΟΤΥΠΩΣΗ ΑΓΡΟΤΕΜΑΧΙΟΥ
ΘΕΣΗ: ΚΤΗΜΑΤΙΚΗ ΠΕΡΙΦΕΡΕΙΑ ΠΑΙΔΑΔΟΥ, ΠΕΡΙΟΧΗ "ΜΑΡΜΑΡΟΥ"

ΜΕΛΕΤΗΤΗΣ: ΑΡΓΥΡΙΟΣ Σ. ΣΚΟΠΕΛΙΤΗΣ
Διπλ. Πολιτικός Μηχανικός Α.Π.Θ.
Μ.Σ.Ε.Μ.Π. ΔΕΛΤΑ ΔΙΑΓΡΑΜΜΟΣ
ΝΑ. ΒΕΝΕΖΗ 24 - ΜΥΤΙΛΗΝΗ ΤΗΛ: 2251103033
Α.Φ.Μ. 132929627 - Α.Ο.Υ. ΜΥΤΙΛΗΝΗΣ

ΤΕΧΝΙΚΟ ΓΡΑΦΕΙΟ
ΑΡΓΥΡΙΟΣ Σ. ΣΚΟΠΕΛΙΤΗΣ
ΔΙΠΛ. ΠΟΛΙΤΙΚΟΣ ΜΗΧΑΝΙΚΟΣ
Αρσενόπουλος Παύλος Θεμιστής, ΜΣ.Ε.Μ.Π.
ΝΑ. ΒΕΝΕΖΗ 24 & ΣΠ. ΜΑΡΜΑΡΟΥ ΤΗΛ. 2251103033
www.arsenopoulos.gr
Μαρίληνη Λι, 05/10/05

ΑΡΙΘΜΟΣ ΣΧΕΔΙΟΥ: ΖΑΧΑΡΙΑΣ ΚΑΜΑΤΟΥ
ΔΕΛΤΑ ΔΙΑΓΡΑΜΜΟΣ
Τ1

ΤΟΠΟΓΡΑΦΙΚΟ ΔΙΑΓΡΑΜΜΑ

ΘΕΩΡΗΘΗΚΕ
ΚΑΤΑ ΤΗΝ ΕΠΙΣΤΗΜΟΝΙΚΗ ΕΠΙΧΕΙΡΗΣΗ
ΑΡΧΙΤΕΚΤΟΝΙΚΟ ΓΡΑΦΕΙΟ
17/09/15
ΚΩΔ. ΜΕΛΕΤΗΣ:
ΣΤΑΔΙΟ ΜΕΛΕΤΗΣ:

ΑΡΓΥΡΙΟΣ Σ. ΣΚΟΠΕΛΙΤΗΣ
ΔΙΠΛ. ΠΟΛΙΤΙΚΟΣ ΜΗΧΑΝΙΚΟΣ Α.Π.Θ.
Μ.Σ.Ε.Μ.Π. ΔΕΛΤΑ ΔΙΑΓΡΑΜΜΟΣ
ΝΑ. ΒΕΝΕΖΗ 24 - ΜΥΤΙΛΗΝΗ ΤΗΛ: 2251103033
Α.Φ.Μ. 132929627 - Α.Ο.Υ. ΜΥΤΙΛΗΝΗΣ

Table with 3 columns: Station, Distance, Elevation. Contains data for the survey points along the boundary.

Table with 3 columns: Station, Distance, Elevation. Contains data for the survey points along the boundary.

Table with 3 columns: Station, Distance, Elevation. Contains data for the survey points along the boundary.

Table with 3 columns: Station, Distance, Elevation. Contains data for the survey points along the boundary.

Table with 3 columns: Station, Distance, Elevation. Contains data for the survey points along the boundary.

Table with 3 columns: Station, Distance, Elevation. Contains data for the survey points along the boundary.

Table with 3 columns: Station, Distance, Elevation. Contains data for the survey points along the boundary.

Table with 3 columns: Station, Distance, Elevation. Contains data for the survey points along the boundary.

Table with 3 columns: Station, Distance, Elevation. Contains data for the survey points along the boundary.

Table with 3 columns: Station, Distance, Elevation. Contains data for the survey points along the boundary.

Table with 3 columns: Station, Distance, Elevation. Contains data for the survey points along the boundary.

Table with 3 columns: Station, Distance, Elevation. Contains data for the survey points along the boundary.

Table with 3 columns: Station, Distance, Elevation. Contains data for the survey points along the boundary.

Table with 3 columns: Station, Distance, Elevation. Contains data for the survey points along the boundary.

Table with 3 columns: Station, Distance, Elevation. Contains data for the survey points along the boundary.

Table with 3 columns: Station, Distance, Elevation. Contains data for the survey points along the boundary.

Table with 3 columns: Station, Distance, Elevation. Contains data for the survey points along the boundary.

Table with 3 columns: Station, Distance, Elevation. Contains data for the survey points along the boundary.

Table with 3 columns: Station, Distance, Elevation. Contains data for the survey points along the boundary.

Table with 3 columns: Station, Distance, Elevation. Contains data for the survey points along the boundary.

Table with 3 columns: Station, Distance, Elevation. Contains data for the survey points along the boundary.

Table with 3 columns: Station, Distance, Elevation. Contains data for the survey points along the boundary.

Table with 3 columns: Station, Distance, Elevation. Contains data for the survey points along the boundary.

Table with 3 columns: Station, Distance, Elevation. Contains data for the survey points along the boundary.

Table with 3 columns: Station, Distance, Elevation. Contains data for the survey points along the boundary.

Table with 3 columns: Station, Distance, Elevation. Contains data for the survey points along the boundary.

Table with 3 columns: Station, Distance, Elevation. Contains data for the survey points along the boundary.

Table with 3 columns: Station, Distance, Elevation. Contains data for the survey points along the boundary.

Table with 3 columns: Station, Distance, Elevation. Contains data for the survey points along the boundary.

Table with 3 columns: Station, Distance, Elevation. Contains data for the survey points along the boundary.

Table with 3 columns: Station, Distance, Elevation. Contains data for the survey points along the boundary.

Table with 3 columns: Station, Distance, Elevation. Contains data for the survey points along the boundary.

Table with 3 columns: Station, Distance, Elevation. Contains data for the survey points along the boundary.

Table with 3 columns: Station, Distance, Elevation. Contains data for the survey points along the boundary.

Table with 3 columns: Station, Distance, Elevation. Contains data for the survey points along the boundary.

Table with 3 columns: Station, Distance, Elevation. Contains data for the survey points along the boundary.

Table with 3 columns: Station, Distance, Elevation. Contains data for the survey points along the boundary.

Table with 3 columns: Station, Distance, Elevation. Contains data for the survey points along the boundary.

Table with 3 columns: Station, Distance, Elevation. Contains data for the survey points along the boundary.

Table with 3 columns: Station, Distance, Elevation. Contains data for the survey points along the boundary.

Table with 3 columns: Station, Distance, Elevation. Contains data for the survey points along the boundary.

Table with 3 columns: Station, Distance, Elevation. Contains data for the survey points along the boundary.

Table with 3 columns: Station, Distance, Elevation. Contains data for the survey points along the boundary.

Table with 3 columns: Station, Distance, Elevation. Contains data for the survey points along the boundary.

Table with 3 columns: Station, Distance, Elevation. Contains data for the survey points along the boundary.

Table with 3 columns: Station, Distance, Elevation. Contains data for the survey points along the boundary.

Table with 3 columns: Station, Distance, Elevation. Contains data for the survey points along the boundary.

Table with 3 columns: Station, Distance, Elevation. Contains data for the survey points along the boundary.

Table with 3 columns: Station, Distance, Elevation. Contains data for the survey points along the boundary.

Table with 3 columns: Station, Distance, Elevation. Contains data for the survey points along the boundary.

Table with 3 columns: Station, Distance, Elevation. Contains data for the survey points along the boundary.

Table with 3 columns: Station, Distance, Elevation. Contains data for the survey points along the boundary.

Table with 3 columns: Station, Distance, Elevation. Contains data for the survey points along the boundary.

Table with 3 columns: Station, Distance, Elevation. Contains data for the survey points along the boundary.

Table with 3 columns: Station, Distance, Elevation. Contains data for the survey points along the boundary.

Table with 3 columns: Station, Distance, Elevation. Contains data for the survey points along the boundary.

Table with 3 columns: Station, Distance, Elevation. Contains data for the survey points along the boundary.

Table with 3 columns: Station, Distance, Elevation. Contains data for the survey points along the boundary.

Table with 3 columns: Station, Distance, Elevation. Contains data for the survey points along the boundary.

Table with 3 columns: Station, Distance, Elevation. Contains data for the survey points along the boundary.

Table with 3 columns: Station, Distance, Elevation. Contains data for the survey points along the boundary.

Table with 3 columns: Station, Distance, Elevation. Contains data for the survey points along the boundary.

Table with 3 columns: Station, Distance, Elevation. Contains data for the survey points along the boundary.

Table with 3 columns: Station, Distance, Elevation. Contains data for the survey points along the boundary.

Table with 3 columns: Station, Distance, Elevation. Contains data for the survey points along the boundary.

Table with 3 columns: Station, Distance, Elevation. Contains data for the survey points along the boundary.

Table with 3 columns: Station, Distance, Elevation. Contains data for the survey points along the boundary.

Table with 3 columns: Station, Distance, Elevation. Contains data for the survey points along the boundary.

Table with 3 columns: Station, Distance, Elevation. Contains data for the survey points along the boundary.

Table with 3 columns: Station, Distance, Elevation. Contains data for the survey points along the boundary.

Table with 3 columns: Station, Distance, Elevation. Contains data for the survey points along the boundary.

Table with 3 columns: Station, Distance, Elevation. Contains data for the survey points along the boundary.

Table with 3 columns: Station, Distance, Elevation. Contains data for the survey points along the boundary.

Table with 3 columns: Station, Distance, Elevation. Contains data for the survey points along the boundary.

Table with 3 columns: Station, Distance, Elevation. Contains data for the survey points along the boundary.

Table with 3 columns: Station, Distance, Elevation. Contains data for the survey points along the boundary.

Table with 3 columns: Station, Distance, Elevation. Contains data for the survey points along the boundary.

Table with 3 columns: Station, Distance, Elevation. Contains data for the survey points along the boundary.

Table with 3 columns: Station, Distance, Elevation. Contains data for the survey points along the boundary.

Table with 3 columns: Station, Distance, Elevation. Contains data for the survey points along the boundary.

Table with 3 columns: Station, Distance, Elevation. Contains data for the survey points along the boundary.

Table with 3 columns: Station, Distance, Elevation. Contains data for the survey points along the boundary.

Table with 3 columns: Station, Distance, Elevation. Contains data for the survey points along the boundary.

Table with 3 columns: Station, Distance, Elevation. Contains data for the survey points along the boundary.

Table with 3 columns: Station, Distance, Elevation. Contains data for the survey points along the boundary.

Table with 3 columns: Station, Distance, Elevation. Contains data for the survey points along the boundary.

Table with 3 columns: Station, Distance, Elevation. Contains data for the survey points along the boundary.

Table with 3 columns: Station, Distance, Elevation. Contains data for the survey points along the boundary.

Table with 3 columns: Station, Distance, Elevation. Contains data for the survey points along the boundary.

Table with 3 columns: Station, Distance, Elevation. Contains data for the survey points along the boundary.

Table with 3 columns: Station, Distance, Elevation. Contains data for the survey points along the boundary.

Table with 3 columns: Station, Distance, Elevation. Contains data for the survey points along the boundary.

Table with 3 columns: Station, Distance, Elevation. Contains data for the survey points along the boundary.

Table with 3 columns: Station, Distance, Elevation. Contains data for the survey points along the boundary.

Table with 3 columns: Station, Distance, Elevation. Contains data for the survey points along the boundary.

Table with 3 columns: Station, Distance, Elevation. Contains data for the survey points along the boundary.

Table with 3 columns: Station, Distance, Elevation. Contains data for the survey points along the boundary.

Table with 3 columns: Station, Distance, Elevation. Contains data for the survey points along the boundary.

Table with 3 columns: Station, Distance, Elevation. Contains data for the survey points along the boundary.

Table with 3 columns: Station, Distance, Elevation. Contains data for the survey points along the boundary.