

ΓΕΩΡΓΗΗ
 Το παρόν τοπογραφικό
 δέλεγμα
 θεωρείται και
 επισημαίνεται στο
 υπ' αριθμ.
 1977/27-06-2016
 έγγραφο μας του
 οποίου αποτελεί στο
 εξής αντιστοιχιστο
 μέρος

Χαλκίδα 27-06-2016
 Ο
 Ειρηγιάννης
 Δήμιος Διπλότυπος

Χαλκίδα 27-06-2016
 Η Δ/ΤΡ ΠΛΗ
 ΔΑΜΟΥ
 Χαλκίδας
 ΠΟΛ. ΣΚΑΦΔΑΚΗ

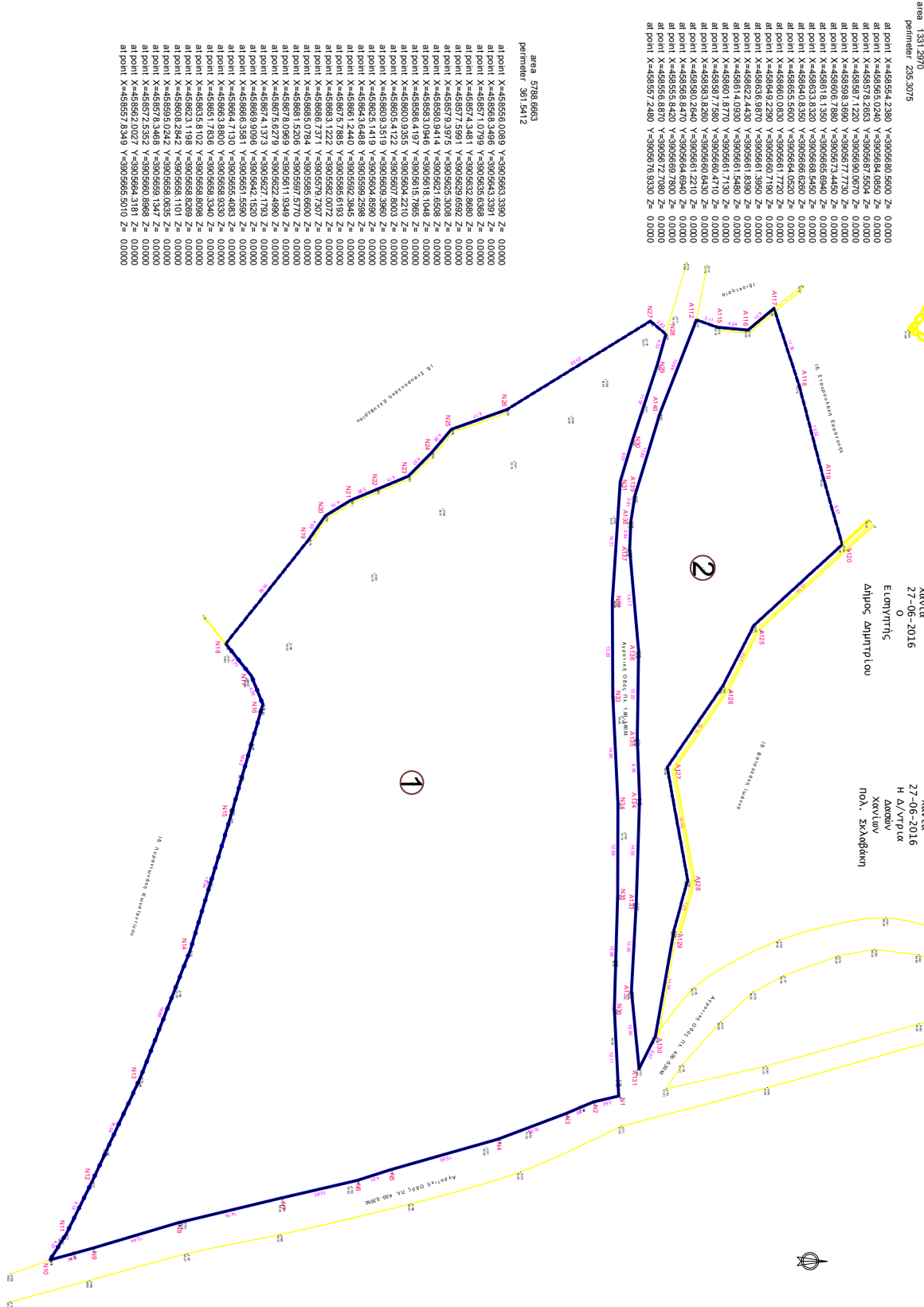

area 5788.6663
 perimeter 3613412

at point X=485954.2380 Y=3905660.5600 Z= 0.0000
 at point X=485955.0240 Y=3905664.0850 Z= 0.0000
 at point X=485919.2503 Y=3905680.7504 Z= 0.0000
 at point X=485918.9000 Y=3905680.0000 Z= 0.0000
 at point X=485958.3680 Y=3905677.7200 Z= 0.0000
 at point X=485966.7880 Y=3905673.4450 Z= 0.0000
 at point X=485961.81350 Y=3905668.8450 Z= 0.0000
 at point X=485963.8320 Y=3905668.8450 Z= 0.0000
 at point X=485940.8350 Y=3905684.8200 Z= 0.0000
 at point X=485918.9000 Y=3905684.8200 Z= 0.0000
 at point X=485969.2290 Y=3905660.7180 Z= 0.0000
 at point X=485966.9870 Y=3905661.3350 Z= 0.0000
 at point X=485922.4430 Y=3905661.5480 Z= 0.0000
 at point X=485914.0930 Y=3905661.5480 Z= 0.0000
 at point X=485918.9000 Y=3905661.7130 Z= 0.0000
 at point X=485933.8280 Y=3905640.4430 Z= 0.0000
 at point X=485933.8280 Y=3905640.4430 Z= 0.0000
 at point X=485958.8470 Y=3905664.6940 Z= 0.0000
 at point X=485955.8420 Y=3905669.7890 Z= 0.0000
 at point X=485955.8870 Y=3905672.7800 Z= 0.0000
 at point X=485957.2480 Y=3905676.9330 Z= 0.0000