

υπαρχουσα αγροτική οδο

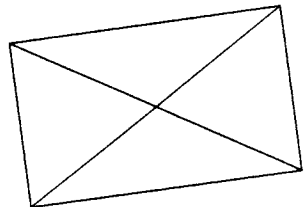
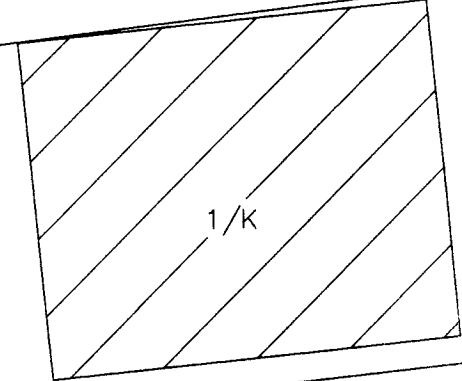
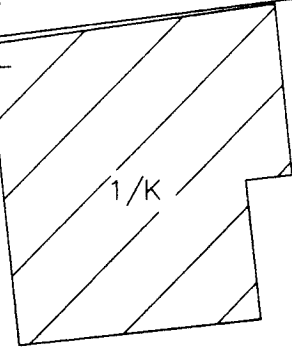
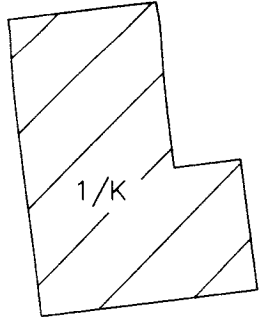
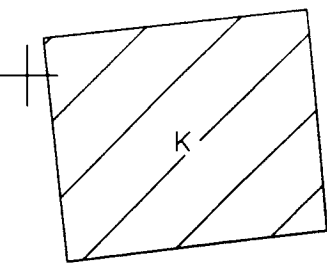
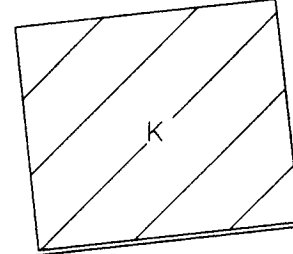
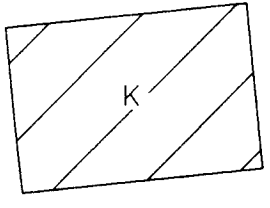

1 B

S1  
6.60

-30.00-

-21.96-

$E_1 = 111,21 \text{ τ.μ}$   
Μη δακτυλ  
(σχ η 3458/99  
πρ. Χαλκιδά)

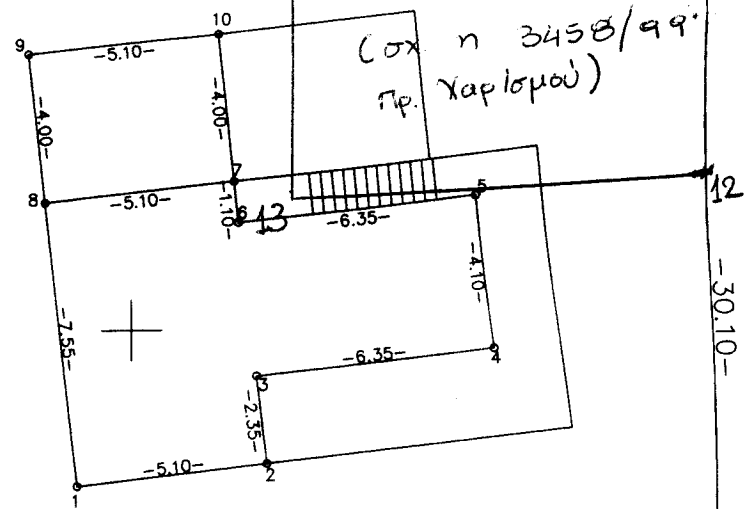

$E = 504,79 \text{ τ.μ}$

-30.10-

S2  
6.78

A

-19.15-

ΣΥΝΟΛΕΥΕΙ ΤΗΝ ΗΒ34/2016  
ΠΡΑΞΗ ΧΑΡΑΚΤΗΡΙΣΜΟΥ  
ΤΗΣ Δ-ΝΣΗΣ ΔΑΣΩΝ ΠΙΕΡΙΑΣ  
ΚΑΤΕΡΙΝΗ (4.06-2018)  
ΓΕΩΡΓΙΟΣ Χ. ΜΑΥΡΪΔΗΣ

Ελεγχθηκε  
28  
N. Ζαμάντζα

υπαρχουσα αγροτική οδο

καμπύλη