

ΕΠΙΜΕΤΡΗΣΗ ΠΕΡΙΦΕΡΕΙΑΣ
των οφειλόμενων διευρυντικών

Σημείο	X	Y	Μήκος
1	222776.6	4178172.88	2.86
2	222778.38	4178171.9	12.82
3	222791.32	4178167.81	11.81
4	222802.5	4178164	5.74
5	222807.93	4178162.14	2.55
6	222810.34	4178161.29	4.43
7	222814.51	4178159.82	1.85
8	222816.26	4178159.23	2.67
9	222817.99	4178157.27	3.97
10	222821.2	4178151.44	8.25
11	222830.26	4178150.36	10.92
12	222832.02	4178152.47	6.58
13	222836.6	4178154.97	7.63
14	222847.5	4178158.04	9.60
15	222907.5	4178191.73	11.86
16	222796.54	4178194.1	7.42
17	222789.52	4178194.1	4.16
18	222787.39	4178190.5	8.30
19	222783.04	4178182.43	12.59
1	222776.6	4178172.88	

E = 1041.99 μ2

ΥΠΟΧΡΩΜΑ ΜΑΘΗΤΩΝ/ΜΑΚΡΟΧΡΩΜΑΤΩΝ

Απόλυτα ανεπίσημο βήμα του Ν.Π.Δ.Δ. 69/77
 01/10/2006 (14/10/2006) 12.3.4. 151, 152 (15/10/14)
 02/10/2006 (14/10/2006) 151, 152 (15/10/14)
 03/10/2006 (14/10/2006) 151, 152 (15/10/14)
 04/10/2006 (14/10/2006) 151, 152 (15/10/14)
 05/10/2006 (14/10/2006) 151, 152 (15/10/14)
 06/10/2006 (14/10/2006) 151, 152 (15/10/14)
 07/10/2006 (14/10/2006) 151, 152 (15/10/14)
 08/10/2006 (14/10/2006) 151, 152 (15/10/14)
 09/10/2006 (14/10/2006) 151, 152 (15/10/14)
 10/10/2006 (14/10/2006) 151, 152 (15/10/14)
 11/10/2006 (14/10/2006) 151, 152 (15/10/14)
 12/10/2006 (14/10/2006) 151, 152 (15/10/14)
 13/10/2006 (14/10/2006) 151, 152 (15/10/14)
 14/10/2006 (14/10/2006) 151, 152 (15/10/14)
 15/10/2006 (14/10/2006) 151, 152 (15/10/14)
 16/10/2006 (14/10/2006) 151, 152 (15/10/14)
 17/10/2006 (14/10/2006) 151, 152 (15/10/14)
 18/10/2006 (14/10/2006) 151, 152 (15/10/14)
 19/10/2006 (14/10/2006) 151, 152 (15/10/14)
 20/10/2006 (14/10/2006) 151, 152 (15/10/14)
 21/10/2006 (14/10/2006) 151, 152 (15/10/14)
 22/10/2006 (14/10/2006) 151, 152 (15/10/14)
 23/10/2006 (14/10/2006) 151, 152 (15/10/14)
 24/10/2006 (14/10/2006) 151, 152 (15/10/14)
 25/10/2006 (14/10/2006) 151, 152 (15/10/14)
 26/10/2006 (14/10/2006) 151, 152 (15/10/14)
 27/10/2006 (14/10/2006) 151, 152 (15/10/14)
 28/10/2006 (14/10/2006) 151, 152 (15/10/14)
 29/10/2006 (14/10/2006) 151, 152 (15/10/14)
 30/10/2006 (14/10/2006) 151, 152 (15/10/14)
 31/10/2006 (14/10/2006) 151, 152 (15/10/14)
 01/11/2006 (14/10/2006) 151, 152 (15/10/14)
 02/11/2006 (14/10/2006) 151, 152 (15/10/14)
 03/11/2006 (14/10/2006) 151, 152 (15/10/14)
 04/11/2006 (14/10/2006) 151, 152 (15/10/14)
 05/11/2006 (14/10/2006) 151, 152 (15/10/14)
 06/11/2006 (14/10/2006) 151, 152 (15/10/14)
 07/11/2006 (14/10/2006) 151, 152 (15/10/14)
 08/11/2006 (14/10/2006) 151, 152 (15/10/14)
 09/11/2006 (14/10/2006) 151, 152 (15/10/14)
 10/11/2006 (14/10/2006) 151, 152 (15/10/14)
 11/11/2006 (14/10/2006) 151, 152 (15/10/14)
 12/11/2006 (14/10/2006) 151, 152 (15/10/14)
 13/11/2006 (14/10/2006) 151, 152 (15/10/14)
 14/11/2006 (14/10/2006) 151, 152 (15/10/14)
 15/11/2006 (14/10/2006) 151, 152 (15/10/14)
 16/11/2006 (14/10/2006) 151, 152 (15/10/14)
 17/11/2006 (14/10/2006) 151, 152 (15/10/14)
 18/11/2006 (14/10/2006) 151, 152 (15/10/14)
 19/11/2006 (14/10/2006) 151, 152 (15/10/14)
 20/11/2006 (14/10/2006) 151, 152 (15/10/14)
 21/11/2006 (14/10/2006) 151, 152 (15/10/14)
 22/11/2006 (14/10/2006) 151, 152 (15/10/14)
 23/11/2006 (14/10/2006) 151, 152 (15/10/14)
 24/11/2006 (14/10/2006) 151, 152 (15/10/14)
 25/11/2006 (14/10/2006) 151, 152 (15/10/14)
 26/11/2006 (14/10/2006) 151, 152 (15/10/14)
 27/11/2006 (14/10/2006) 151, 152 (15/10/14)
 28/11/2006 (14/10/2006) 151, 152 (15/10/14)
 29/11/2006 (14/10/2006) 151, 152 (15/10/14)
 30/11/2006 (14/10/2006) 151, 152 (15/10/14)
 01/12/2006 (14/10/2006) 151, 152 (15/10/14)
 02/12/2006 (14/10/2006) 151, 152 (15/10/14)
 03/12/2006 (14/10/2006) 151, 152 (15/10/14)
 04/12/2006 (14/10/2006) 151, 152 (15/10/14)
 05/12/2006 (14/10/2006) 151, 152 (15/10/14)
 06/12/2006 (14/10/2006) 151, 152 (15/10/14)
 07/12/2006 (14/10/2006) 151, 152 (15/10/14)
 08/12/2006 (14/10/2006) 151, 152 (15/10/14)
 09/12/2006 (14/10/2006) 151, 152 (15/10/14)
 10/12/2006 (14/10/2006) 151, 152 (15/10/14)
 11/12/2006 (14/10/2006) 151, 152 (15/10/14)
 12/12/2006 (14/10/2006) 151, 152 (15/10/14)
 13/12/2006 (14/10/2006) 151, 152 (15/10/14)
 14/12/2006 (14/10/2006) 151, 152 (15/10/14)
 15/12/2006 (14/10/2006) 151, 152 (15/10/14)
 16/12/2006 (14/10/2006) 151, 152 (15/10/14)
 17/12/2006 (14/10/2006) 151, 152 (15/10/14)
 18/12/2006 (14/10/2006) 151, 152 (15/10/14)
 19/12/2006 (14/10/2006) 151, 152 (15/10/14)
 20/12/2006 (14/10/2006) 151, 152 (15/10/14)
 21/12/2006 (14/10/2006) 151, 152 (15/10/14)
 22/12/2006 (14/10/2006) 151, 152 (15/10/14)
 23/12/2006 (14/10/2006) 151, 152 (15/10/14)
 24/12/2006 (14/10/2006) 151, 152 (15/10/14)
 25/12/2006 (14/10/2006) 151, 152 (15/10/14)
 26/12/2006 (14/10/2006) 151, 152 (15/10/14)
 27/12/2006 (14/10/2006) 151, 152 (15/10/14)
 28/12/2006 (14/10/2006) 151, 152 (15/10/14)
 29/12/2006 (14/10/2006) 151, 152 (15/10/14)
 30/12/2006 (14/10/2006) 151, 152 (15/10/14)
 31/12/2006 (14/10/2006) 151, 152 (15/10/14)

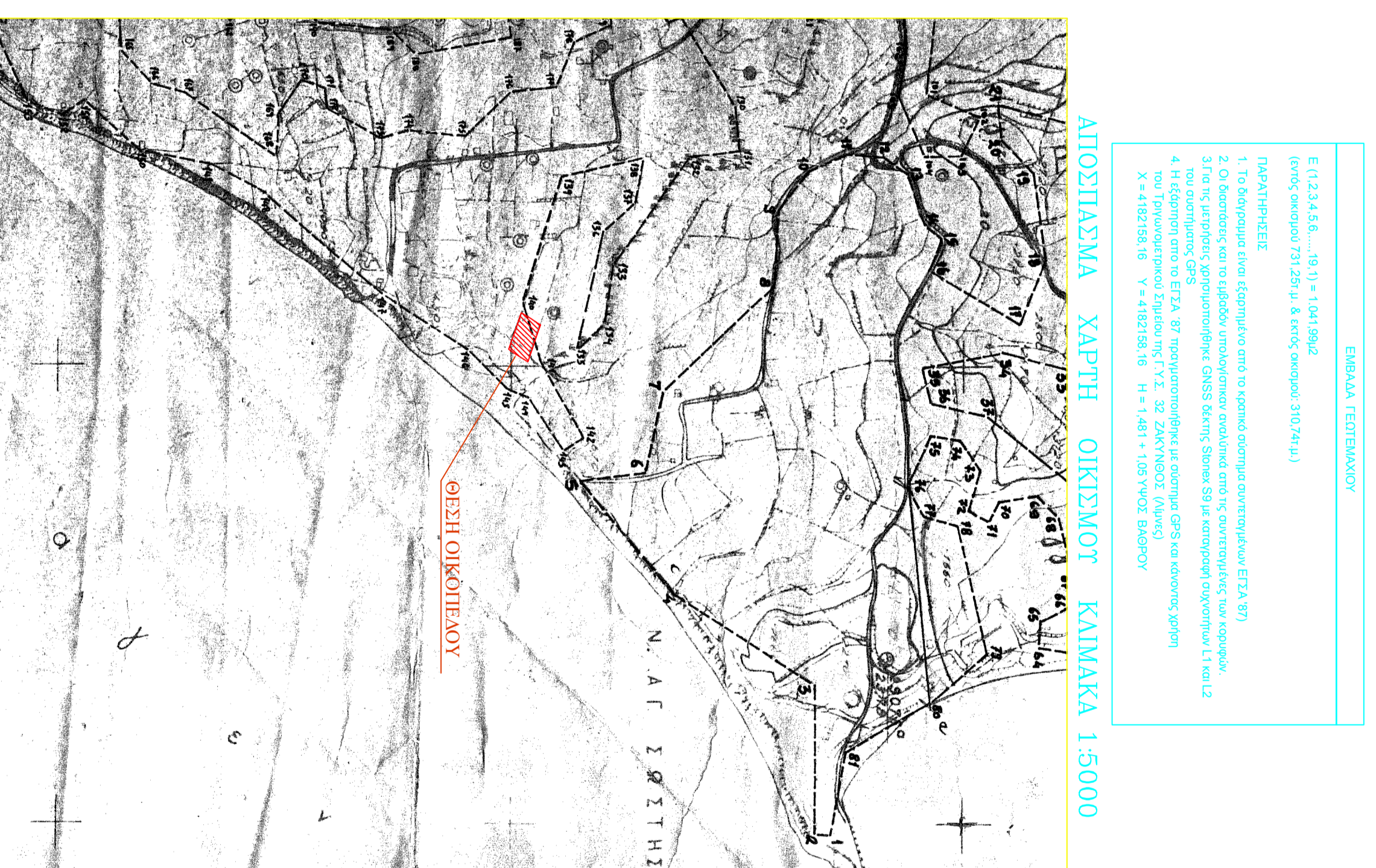

Αλέξανδρος Μπούας
Πολιτικός Μηχανικός
 Beng Civil Engineering University of Portsmouth
 MSc Civil Engineering University of Surrey

Ομήρων Καροχίε 43
 Ζάκυνθος
 Τ.Κ. 29100

Εργοδότης
 Στάυπος Κακοθύρης

Έργο
 Αποτύπωση Τοπογραφικού
 Διαγράμματος

Θέση Έργου
 Δ.Κ. Λιβακιάς (Αν. Σύστης)
 Δ.Ε. Λαγανά, Δήμος Ζακύνθου

Θέμα Σχεδίου
 Τοπογραφικό Διάγραμμα

Μελετητής
 Αλέξανδρος Μπούας

Κλίμακες
 1:200

Ημερομηνία
 Αύγουστος 2016

Εξώφληση Υπερεστίας
 Σφραγίδα

