

Station	X	Y	Station	X	Y
1	115009.76	423128.71	21	115097.98	423136.41
2	115009.76	423128.71	22	115097.98	423136.41
3	115018.48	423131.18	23	115097.98	423136.41
4	115018.48	423131.18	24	115097.98	423136.41
5	115018.48	423131.18	25	115097.98	423136.41
6	115018.48	423131.18	26	115097.98	423136.41
7	115018.48	423131.18	27	115097.98	423136.41
8	115018.48	423131.18	28	115097.98	423136.41
9	115018.48	423131.18	29	115097.98	423136.41
10	115018.48	423131.18	30	115097.98	423136.41
11	115018.48	423131.18	31	115097.98	423136.41
12	115018.48	423131.18	32	115097.98	423136.41
13	115018.48	423131.18	33	115097.98	423136.41
14	115018.48	423131.18	34	115097.98	423136.41
15	115018.48	423131.18	35	115097.98	423136.41
16	115018.48	423131.18	36	115097.98	423136.41
17	115018.48	423131.18	37	115097.98	423136.41
18	115018.48	423131.18	38	115097.98	423136.41
19	115018.48	423131.18	39	115097.98	423136.41
20	115018.48	423131.18	40	115097.98	423136.41

Station	X	Y	Station	X	Y
41	115097.98	423136.41	51	115097.98	423136.41
42	115097.98	423136.41	52	115097.98	423136.41
43	115097.98	423136.41	53	115097.98	423136.41
44	115097.98	423136.41	54	115097.98	423136.41
45	115097.98	423136.41	55	115097.98	423136.41
46	115097.98	423136.41	56	115097.98	423136.41
47	115097.98	423136.41	57	115097.98	423136.41
48	115097.98	423136.41	58	115097.98	423136.41
49	115097.98	423136.41	59	115097.98	423136.41
50	115097.98	423136.41	60	115097.98	423136.41

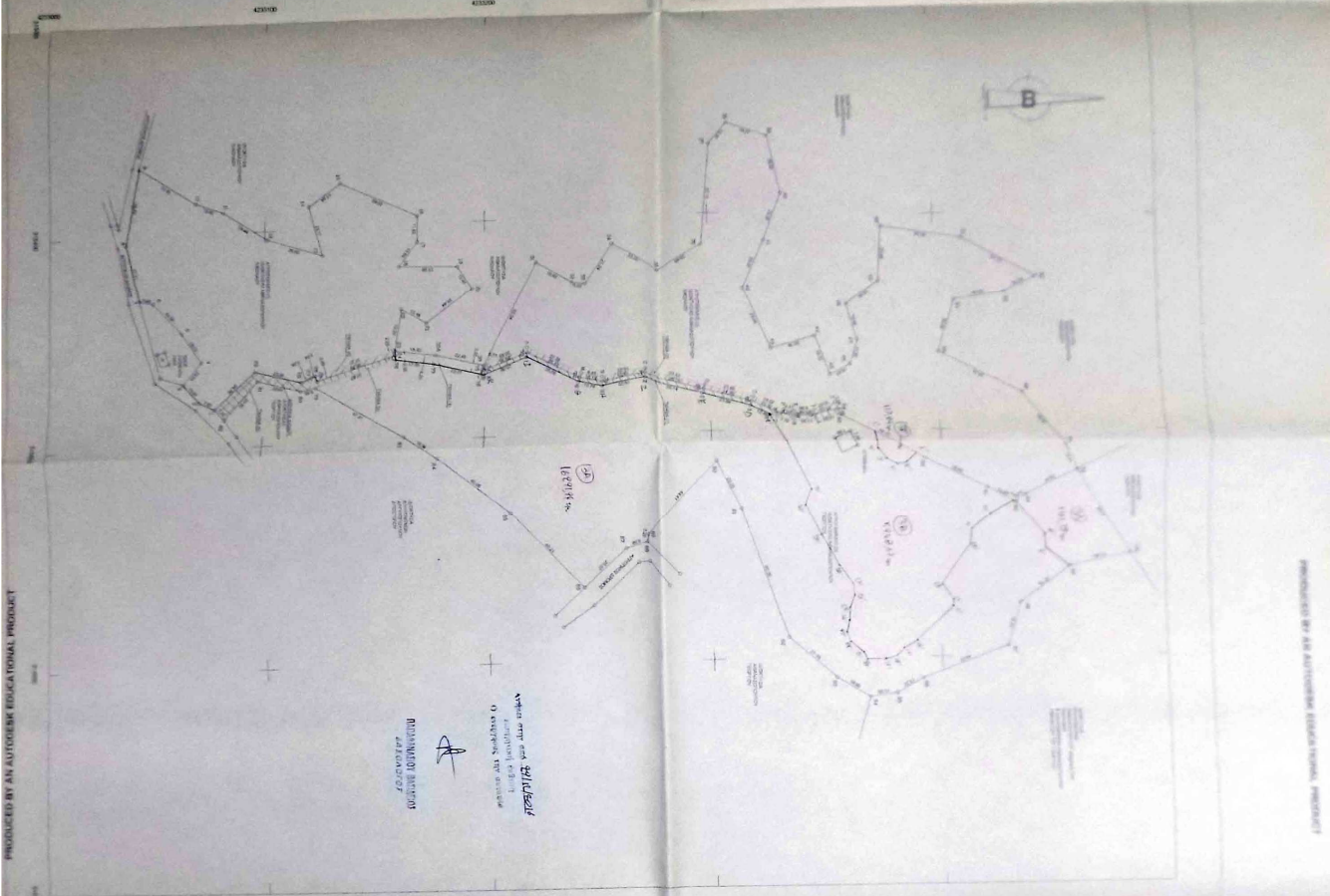

PRODUCED BY AN AUTODESK EDUCATIONAL PRODUCT

PRODUCED BY AN AUTODESK EDUCATIONAL PRODUCT



**ΠΙΝΑΚΑΣ ΕΠΙΒΑΛΟΜΕΝΩΝ**

Αριθμοί των επιβαλλόμενων σημείων, αποστάσεις και κλίσεις των επιβαλλόμενων σημείων, καθώς και οι κλίσεις των επιβαλλόμενων σημείων.

ΟΝΟΜΑΤΑ ΤΩΝ ΣΤΑΘΜΩΝ ΚΑΙ ΤΩΝ ΣΕΚΤΩΡΩΝ

ΟΝΟΜΑΤΑ ΤΩΝ ΣΤΑΘΜΩΝ ΚΑΙ ΤΩΝ ΣΕΚΤΩΡΩΝ

ΟΝΟΜΑΤΑ ΤΩΝ ΣΤΑΘΜΩΝ ΚΑΙ ΤΩΝ ΣΕΚΤΩΡΩΝ

ΟΝΟΜΑΤΑ ΤΩΝ ΣΤΑΘΜΩΝ ΚΑΙ ΤΩΝ ΣΕΚΤΩΡΩΝ

ΟΝΟΜΑΤΑ ΤΩΝ ΣΤΑΘΜΩΝ ΚΑΙ ΤΩΝ ΣΕΚΤΩΡΩΝ

ΟΝΟΜΑΤΑ ΤΩΝ ΣΤΑΘΜΩΝ ΚΑΙ ΤΩΝ ΣΕΚΤΩΡΩΝ

**ΤΕΧΝΙΚΟ ΓΡΑΦΕΙΟ**

**ΝΙΚΟΛΑΟΣ ΕΥΘ. ΠΑΝΑΡΟΣ**

**ΠΟΛΙΤΙΚΟΣ ΜΗΧΑΝΙΚΟΣ Τ.Ε.**

Μαροθωλουδών 75 ΣΤ 2Τ Πάτρα  
ΤΗΛ. 2610 - 642 596 ΤΗΛ. 6945 - 904 675

Εργοδοτής:

- 1) Αβρααμόπουλος Νικόλαος
- 2) Αβρααμόπουλος Γεώργιος

Εργο:

Αποτύπωση Απορρυτιχίου

Όσον:

Δήμος Εργίδου Δ.Δ. Σαλαμίνιου  
Όσον "Προβλήτη Ηλιού"

Μελέτητής:

Νικόλαος Γεωργιάδης Πλατ. Μηνεμίδος 1, Ε  
Αθήνα Σχολίου

Κλίμακα:

1:1000

Σχολιάζων:

Σεπτέμβριος 2008

Καλλιόπη

Topographic map showing terrain contours and a survey network. The map includes a north arrow and a scale bar. The network consists of several interconnected points, with bearings and distances provided for each segment. The map is titled 'ΠΡΟΤΥΠΟ ΚΑΤΑΣΤΑΣΗ' and includes a legend for 'ΑΝΩΤΕΡΟΙ ΚΑΙ ΚΑΤΩΤΕΡΟΙ ΣΤΑΘΜΟΙ'.

ΕΜΒΑΔΟΜΕΤΡΗΣΗ ΑΓΡΟΤΕΜΑΧΙΟΥ(3)

Με τη βοήθεια των ορθογωνικών συντεταγμένων των κορυφών του

ΣΗΜΕΙΟ	X	Y	ΜΗΚΟΣ
78	315462.46	4233159.80	2.05
24	315460.41	4233159.65	36.78
25	315470.68	4233124.33	2.68
26	315468.12	4233123.53	2.04
27	315468.90	4233121.65	5.05
28	315470.84	4233116.98	22.24
29	315464.97	4233095.52	24.76
1	315481.71	4233077.28	7.05
82	315486.85	4233082.10	22.82
81	315469.50	4233096.92	20.61
80	315474.94	4233116.80	6.95
79	315473.70	4233123.64	47.31
83	315498.40	4233163.98	18.34
84	315508.93	4233178.99	40.05
85	315533.84	4233210.36	46.21
86	315567.52	4233242.00	25.07
87	315550.99	4233260.85	9.96
88	315548.37	4233270.46	3.25
89	315545.17	4233271.05	44.41
90	315513.37	4233302.05	23.25
91	315534.09	4233312.59	60.26
92	315590.80	4233332.97	27.35
93	315608.67	4233353.68	16.68
94	315617.32	4233367.94	12.05
95	315615.82	4233379.89	13.23
96	315609.41	4233391.47	40.27
97	315595.52	4233429.27	19.79
98	315576.63	4233435.14	27.19
99	315560.93	4233457.34	27.88
100	315554.97	4233484.57	44.15
58	315518.19	4233460.14	25.07
59	315528.95	4233437.49	5.52
60	315532.40	4233433.18	13.96
61	315525.87	4233420.83	30.65
62	315513.04	4233393.00	42.10
63	315492.59	4233356.20	2.98
64	315489.75	4233355.30	10.27
65	315492.52	4233345.41	9.44
66	315492.93	4233335.99	6.07
67	315491.81	4233330.02	13.32
68	315486.01	4233318.02	21.78
69	315480.25	4233297.02	26.78
70	315473.69	4233271.05	19.23
71	315476.99	4233252.11	10.12
72	315474.59	4233242.29	26.73
73	315461.98	4233218.72	20.35
74	315469.05	4233199.64	0.73
75	315468.86	4233198.94	2.00
76	315470.79	4233198.42	22.27
77	315465.10	4233176.89	17.30
78	315462.46	4233159.80	

$$E=1/2 \sum(X_i + X_{i+1})(Y_i - Y_{i+1})$$

$$E = 23519.74 \mu^2$$

ΕΜΒΑΔΟΜΕΤΡΗΣΗ ΑΓΡΟΤΕΜΑΧΙΟΥ(1)

Με τη βοήθεια των ορθογωνικών συντεταγμένων των κορυφών του

ΣΗΜΕΙΟ	X	Y	ΜΗΚΟΣ
1	315481.71	4233077.28	7.87
2	315478.31	4233070.17	11.57
3	315469.60	4233062.57	13.01
4	315469.53	4233070.80	16.73
5	315445.76	4233061.29	19.38
6	315431.48	4233048.19	6.60
7	315429.99	4233041.76	27.11
8	315403.64	4233035.39	35.48
9	315368.79	4233042.04	31.19
10	315385.81	4233068.18	13.42
11	315390.66	4233080.69	24.44
12	315403.96	4233101.20	26.60
13	315412.54	4233126.38	23.77
14	315389.61	4233120.10	17.64
15	315379.51	4233134.56	39.03
16	315396.36	4233169.77	11.82
17	315408.18	4233169.53	13.89
18	315419.28	4233161.18	26.53
19	315420.53	4233187.67	12.46
20	315431.15	4233194.21	25.44
21	315446.08	4233173.61	13.16
22	315439.28	4233162.34	19.30
23	315458.36	4233159.50	2.05
24	315460.41	4233159.65	36.78
25	315470.68	4233124.33	2.68
26	315468.12	4233123.53	2.04
27	315468.90	4233121.65	5.05
28	315470.84	4233116.98	22.24
29	315464.97	4233095.52	24.76
1	315481.71	4233077.28	

$$E=1/2 \sum(X_i + X_{i+1})(Y_i - Y_{i+1})$$

$$E = 9691.05 \mu^2$$

ΕΜΒΑΔΟΜΕΤΡΗΣΗ ΑΓΡΟΤΕΜΑΧΙΟΥ(2)

Με τη βοήθεια των ορθογωνικών συντεταγμένων των κορυφών του

ΣΗΜΕΙΟ	X	Y	ΜΗΚΟΣ
30	315466.93	4233199.45	52.04
31	315420.55	4233223.05	18.93
32	315430.80	4233238.97	6.02
33	315431.71	4233244.91	21.24
34	315414.21	4233256.96	23.00
35	315425.26	4233277.14	22.68
36	315414.35	4233297.02	47.15
37	315367.40	4233301.30	12.37
38	315357.75	4233309.04	19.27
39	315364.21	4233327.19	26.96
40	315390.60	4233332.69	23.37
41	315412.53	4233324.59	23.97
42	315434.48	4233314.97	29.98
43	315462.03	4233326.80	20.36
44	315456.31	4233346.35	18.72
45	315473.94	4233352.64	10.07
46	315469.31	4233361.58	11.91
47	315457.93	4233365.09	16.85
48	315441.76	4233360.35	18.16
49	315431.00	4233374.97	25.46
50	315405.61	4233376.77	36.18
51	315410.92	4233412.53	37.15
52	315428.35	4233445.34	16.19
53	315435.77	4233430.95	22.59
54	315439.45	4233408.66	25.03
55	315463.22	4233400.82	41.05
56	315482.09	4233437.28	30.50
57	315507.21	4233454.58	12.31
58	315518.19	4233460.14	25.07
59	315528.95	4233437.49	5.52
60	315532.40	4233433.18	13.96
61	315525.87	4233420.83	30.65
62	315513.04	4233393.00	42.10
63	315492.59	4233356.20	2.98
64	315489.75	4233355.30	10.27
65	315492.52	4233345.41	9.44
66	315492.93	4233335.99	6.07
67	315491.81	4233330.02	13.32
68	315486.01	4233318.02	21.78
69	315480.25	4233297.02	26.78
70	315473.69	4233271.05	19.23
71	315476.99	4233252.11	10.12
72	315474.59	4233242.29	26.73
73	315461.98	4233218.72	20.35
74	315469.05	4233199.64	0.73
75	315468.86	4233198.94	2.00
30	315466.93	4233199.45	
30A	315461.18	4233177.71	

$$E=1/2 \sum(X_i + X_{i+1})(Y_i - Y_{i+1})$$

$$E = 15553.42 \mu^2$$

44	315456.31	4233346.35	18.72
45	315473.94	4233352.64	10.07
46	315469.31	4233361.58	11.91
47	315457.93	4233365.09	16.85
48	315441.76	4233360.35	18.16
49	315431.00	4233374.97	25.46
50	315405.61	4233376.77	36.16
51	315410.92	4233412.53	37.15
52	315428.35	4233445.34	16.19
53	315435.77	4233430.95	22.59
54	315439.45	4233408.66	25.03
55	315463.22	4233400.82	41.05
56	315482.09	4233437.28	30.50
57	315507.21	4233454.58	12.31
58	315518.19	4233460.14	25.07
59	315528.95	4233437.49	5.52
60	315532.40	4233433.18	13.98
61	315525.87	4233420.83	30.65
62	315513.04	4233393.00	42.10
63	315492.59	4233356.20	2.98
64	315489.75	4233355.30	10.27
65	315492.52	4233345.41	9.44
66	315492.93	4233335.99	6.07
67	315491.81	4233330.02	13.32
68	315486.01	4233318.02	21.78
69	315480.25	4233297.02	26.78
70	315473.69	4233271.05	19.23
71	315476.99	4233252.11	10.12
72	315474.59	4233242.29	26.73
73	315461.98	4233218.72	20.35
74	315469.05	4233199.64	0.73
75	315468.86	4233198.94	2.00
30	315466.93	4233199.45	
30A	315461.18	4233177.71	

$$E = 1/2 \sum (X_i + X_{i+1})(\Psi_i - \Psi_{i+1})$$

$$E = 15553.42 \mu^2$$



Σημείο	X	Y	Σημείο	X	Y
1'	315500.70	4233370.79	21'	315597.08	4233364.41
2'	315507.05	4233370.37	22'	315591.59	4233358.56
3'	315512.19	4233375.02	23'	315587.80	4233356.68
4'	315514.83	4233381.18	24'	315582.69	4233358.32
5'	315513.69	4233383.66	25'	315577.54	4233358.80
6'	315509.97	4233387.47	26'	315571.70	4233361.29
7'	315552.54	4233446.37	27'	315566.88	4233360.21
8'	315546.10	4233446.07	28'	315558.99	4233354.16
9'	315531.29	4233431.09	29'	315545.24	4233346.83
10'	315536.23	4233421.49	30'	315531.66	4233339.88
11'	315543.59	4233413.47	31'	315524.65	4233343.15
12'	315550.22	4233413.43	32'	315491.43	4233324.63
13'	315567.95	4233399.03			
14'	315574.70	4233404.64	Δ	315487.89	4233317.32
15'	315577.43	4233404.21	E	315482.18	4233296.51
16'	315591.32	4233388.63	Z	315475.73	4233270.98
17'	315595.23	4233381.89	H	315479.03	4233252.05
18'	315598.02	4233378.97	Θ	315476.47	4233241.56
19'	315599.76	4233373.28	I	315464.16	4233218.57
20'	315599.28	4233365.66	K	315471.14	4233199.74