

ΜΟΝΟΤΡΑΦΗ	ΕΥΡΩΚΑΤΩΝΗ	Δ/ΝΤΗΣΑ
ΟΡΘΟΓΩΝΙΟΜΕΤΡΟ	Λησισακελ Αντ	Β. Βαββας
ΗΜΕΡΟΜΗΝΙΑ	24-02-2017	24.02.17

Πράξη χαρακτηρισμού με αρ.  
πρωτ. 39833/23-02-2017 του  
Τριβόλη Στυπιδωρα του  
Τριπικλή

ΑΔΑ: 64ΤΔΟΡ1Φ-065

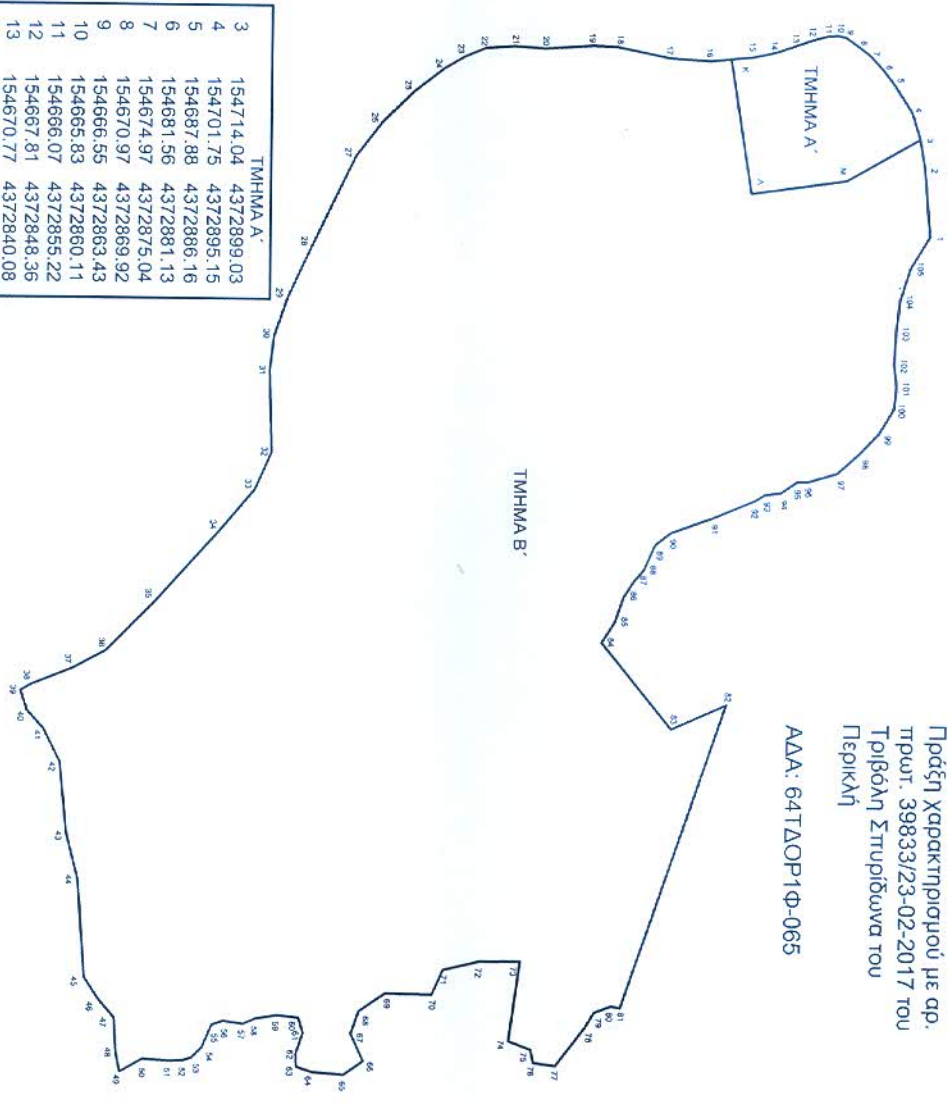

3	154714.04	4372899.03	TMHMA A'
4	154701.75	4372895.15	
5	154687.88	4372886.16	
6	154681.56	4372881.13	
7	154674.97	4372875.04	
8	154670.97	4372869.92	
9	154666.55	4372863.43	
10	154666.83	4372860.11	
11	154666.07	4372855.22	
12	154667.81	4372848.36	
13	154670.77	4372840.08	
14	154674.14	4372830.21	
15	154676.33	4372819.64	
K	154677.33	4372809.62	
Λ	154740.51	4372819.78	
M	154734.16	4372864.17	
3	154714.04	4372899.03	

1	154759.85	4372904.04	TMHMA B'	59	155129.79	4372699.39
2	154728.39	4372901.36		60	155130.90	4372609.89
3	154714.04	4372899.03		61	155137.84	4372611.92
M	154734.16	4372864.17		62	155147.65	4372608.69
Λ	154740.51	4372819.78		63	155153.81	4372609.12
K	154677.33	4372809.62		64	155156.22	4372616.47
16	154678.33	4372799.60		65	155157.33	4372631.11
17	154677.11	4372780.66		66	155150.77	4372640.38
18	154672.16	4372755.60		67	155137.96	4372634.50
19	154671.71	4372743.71		68	155127.22	4372638.13
20	154673.15	4372721.50		69	155118.79	4372650.16
21	154672.30	4372706.93		70	155119.04	4372672.39
22	154673.19	4372692.86		71	155107.39	4372677.59
23	154677.11	4372683.20		72	155103.34	4372694.55
24	154682.95	4372673.36		73	155103.14	4372714.21
25	154693.41	4372659.96		74	155140.58	4372709.12
26	154708.19	4372644.69		75	155144.51	4372719.66
27	154724.57	4372632.31		76	155150.77	4372721.23
28	154766.87	4372612.32		77	155151.98	4372731.34
29	154791.20	4372601.06		78	155133.76	4372745.20
30	154809.70	4372594.63		79	155126.70	4372749.56
31	154825.73	4372592.62		80	155123.65	4372757.44
32	154864.71	4372593.65		81	155124.52	4372761.82
33	154882.20	4372586.11		82	154981.27	4372810.32
34	154901.67	4372569.53		83	154992.88	4372784.30
35	154934.98	4372539.75		84	154952.38	4372750.86
36	154958.48	4372516.49		85	154942.80	4372757.14
37	154967.25	4372500.11		86	154930.40	4372761.41
38	154975.04	4372480.29		87	154923.17	4372766.07
39	154977.74	4372475.48		88	154918.13	4372770.55
40	154987.39	4372478.84		89	154906.07	4372775.88
41	154995.63	4372486.75		90	154900.68	4372782.99
42	155011.46	4372495.04		91	154893.63	4372802.41
43	155045.31	4372498.97		92	154885.04	4372827.32
44	155066.48	4372504.55		93	154882.34	4372827.32
45	155112.79	4372508.13		94	154881.48	4372834.93
46	155123.01	4372515.10		95	154876.14	4372842.60
47	155131.82	4372522.61		96	154876.15	4372847.56
48	155147.54	4372523.80		97	154872.00	4372861.36
49	155156.85	4372525.64		98	154862.76	4372871.73
50	155150.94	4372536.04		99	154852.98	4372880.92
51	155151.71	4372549.32		100	154841.16	4372887.79
52	155151.36	4372555.56		101	154830.96	4372888.89
53	155150.09	4372559.60		102	154820.64	4372887.70
54	155144.99	4372564.46		103	154805.59	4372888.46
55	155134.45	4372568.81		104	154790.50	4372890.15
56	155132.69	4372574.02		105	154774.78	4372895.05
57	155133.89	4372583.34				
58	155131.40	4372589.08		1	154759.85	4372904.04