

10. INITIAL STATE PLAN WITH INITIAL DATA (1) K. N. = 1:100000

Point	X	Y
1	121350.00	425120.00
2	121350.00	425120.00
3	121350.00	425120.00
4	121350.00	425120.00

- 1. L. 2166/2002 - Construction of a residential building with a total area of 10,000 sq. m.
- 2. L. 100/2003 - Construction of a residential building with a total area of 10,000 sq. m.
- 3. L. 100/2003 - Construction of a residential building with a total area of 10,000 sq. m.
- 4. L. 100/2003 - Construction of a residential building with a total area of 10,000 sq. m.
- 5. L. 100/2003 - Construction of a residential building with a total area of 10,000 sq. m.
- 6. L. 100/2003 - Construction of a residential building with a total area of 10,000 sq. m.
- 7. L. 100/2003 - Construction of a residential building with a total area of 10,000 sq. m.
- 8. L. 100/2003 - Construction of a residential building with a total area of 10,000 sq. m.
- 9. L. 100/2003 - Construction of a residential building with a total area of 10,000 sq. m.
- 10. L. 100/2003 - Construction of a residential building with a total area of 10,000 sq. m.

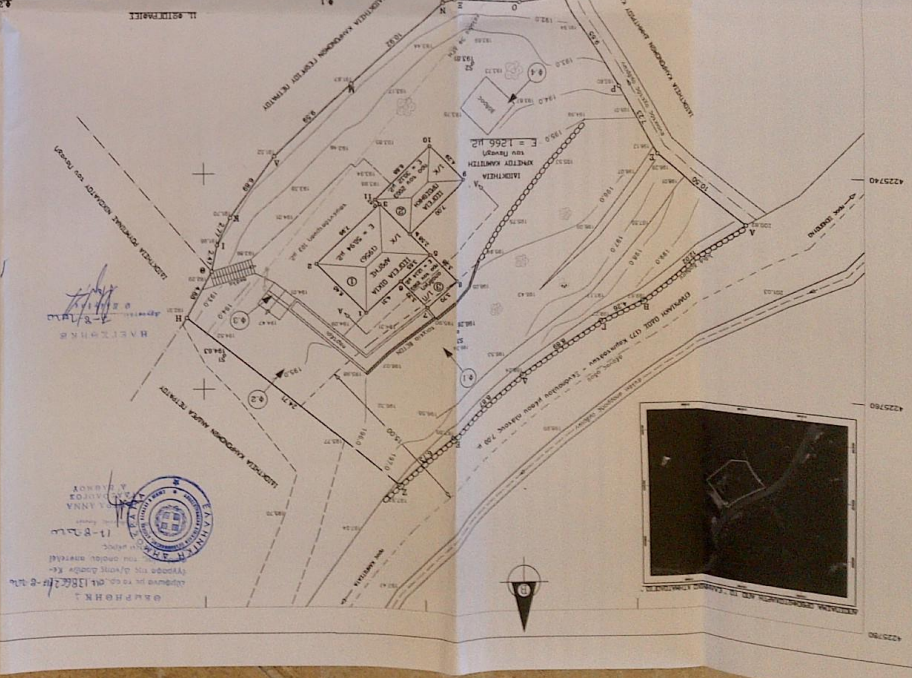
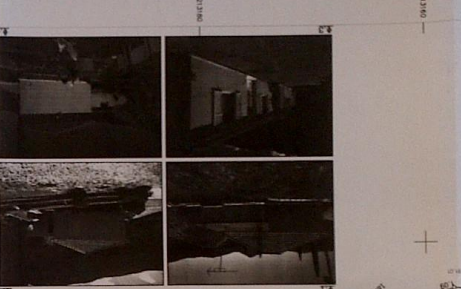

1. GENERAL PLAN - ESTIMATION & DESIGN PROVISIONS

Item	Code	Description	Quantity	Unit	Value
1.1	1.1.1	Excavation	100	m³	1000
1.2	1.2.1	Foundation	200	m³	2000
1.3	1.3.1	Structural	300	m³	3000
1.4	1.4.1	Roofing	400	m³	4000
1.5	1.5.1	Internal	500	m³	5000
1.6	1.6.1	External	600	m³	6000
1.7	1.7.1	Other	700	m³	7000
1.8	1.8.1	Total	2200	m³	22000

2. ANALYSIS OF THE PROJECT

Item	Code	Description	Quantity	Unit	Value
2.1	2.1.1	Excavation	100	m³	1000
2.2	2.2.1	Foundation	200	m³	2000
2.3	2.3.1	Structural	300	m³	3000
2.4	2.4.1	Roofing	400	m³	4000
2.5	2.5.1	Internal	500	m³	5000
2.6	2.6.1	External	600	m³	6000
2.7	2.7.1	Other	700	m³	7000
2.8	2.8.1	Total	2200	m³	22000

3. ANALYSIS OF THE PROJECT

3.1. ANALYSIS OF THE PROJECT

3.2. ANALYSIS OF THE PROJECT

3.3. ANALYSIS OF THE PROJECT

3.4. ANALYSIS OF THE PROJECT

3.5. ANALYSIS OF THE PROJECT

3.6. ANALYSIS OF THE PROJECT

3.7. ANALYSIS OF THE PROJECT

3.8. ANALYSIS OF THE PROJECT

3.9. ANALYSIS OF THE PROJECT

3.10. ANALYSIS OF THE PROJECT

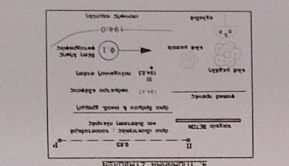

4. TECHNICAL DRAWINGS

4.1. TECHNICAL DRAWINGS

4.2. TECHNICAL DRAWINGS

4.3. TECHNICAL DRAWINGS

4.4. TECHNICAL DRAWINGS

4.5. TECHNICAL DRAWINGS

4.6. TECHNICAL DRAWINGS

4.7. TECHNICAL DRAWINGS

4.8. TECHNICAL DRAWINGS

4.9. TECHNICAL DRAWINGS

4.10. TECHNICAL DRAWINGS

5. TECHNICAL DRAWINGS

5.1. TECHNICAL DRAWINGS

5.2. TECHNICAL DRAWINGS

5.3. TECHNICAL DRAWINGS

5.4. TECHNICAL DRAWINGS

5.5. TECHNICAL DRAWINGS

5.6. TECHNICAL DRAWINGS

5.7. TECHNICAL DRAWINGS

5.8. TECHNICAL DRAWINGS

5.9. TECHNICAL DRAWINGS

5.10. TECHNICAL DRAWINGS

6. TECHNICAL DRAWINGS

6.1. TECHNICAL DRAWINGS

6.2. TECHNICAL DRAWINGS

6.3. TECHNICAL DRAWINGS

6.4. TECHNICAL DRAWINGS

6.5. TECHNICAL DRAWINGS

6.6. TECHNICAL DRAWINGS

6.7. TECHNICAL DRAWINGS

6.8. TECHNICAL DRAWINGS

6.9. TECHNICAL DRAWINGS

6.10. TECHNICAL DRAWINGS

7. TECHNICAL DRAWINGS

7.1. TECHNICAL DRAWINGS

7.2. TECHNICAL DRAWINGS

7.3. TECHNICAL DRAWINGS

7.4. TECHNICAL DRAWINGS

7.5. TECHNICAL DRAWINGS

7.6. TECHNICAL DRAWINGS

7.7. TECHNICAL DRAWINGS

7.8. TECHNICAL DRAWINGS

7.9. TECHNICAL DRAWINGS

7.10. TECHNICAL DRAWINGS

Handwritten signature

1. GENERAL PLAN - ESTIMATION & DESIGN PROVISIONS

Item	Code	Description	Quantity	Unit	Value
1.1	1.1.1	Excavation	100	m³	1000
1.2	1.2.1	Foundation	200	m³	2000
1.3	1.3.1	Structural	300	m³	3000
1.4	1.4.1	Roofing	400	m³	4000
1.5	1.5.1	Internal	500	m³	5000
1.6	1.6.1	External	600	m³	6000
1.7	1.7.1	Other	700	m³	7000
1.8	1.8.1	Total	2200	m³	22000

Handwritten signature

2. ANALYSIS OF THE PROJECT

2.1. ANALYSIS OF THE PROJECT

2.2. ANALYSIS OF THE PROJECT

2.3. ANALYSIS OF THE PROJECT

2.4. ANALYSIS OF THE PROJECT

2.5. ANALYSIS OF THE PROJECT

2.6. ANALYSIS OF THE PROJECT

2.7. ANALYSIS OF THE PROJECT

2.8. ANALYSIS OF THE PROJECT

2.9. ANALYSIS OF THE PROJECT

2.10. ANALYSIS OF THE PROJECT

3. ANALYSIS OF THE PROJECT

3.1. ANALYSIS OF THE PROJECT

3.2. ANALYSIS OF THE PROJECT

3.3. ANALYSIS OF THE PROJECT

3.4. ANALYSIS OF THE PROJECT

3.5. ANALYSIS OF THE PROJECT

3.6. ANALYSIS OF THE PROJECT

3.7. ANALYSIS OF THE PROJECT

3.8. ANALYSIS OF THE PROJECT

3.9. ANALYSIS OF THE PROJECT

3.10. ANALYSIS OF THE PROJECT

4. ANALYSIS OF THE PROJECT

4.1. ANALYSIS OF THE PROJECT

4.2. ANALYSIS OF THE PROJECT

4.3. ANALYSIS OF THE PROJECT

4.4. ANALYSIS OF THE PROJECT

4.5. ANALYSIS OF THE PROJECT

4.6. ANALYSIS OF THE PROJECT

4.7. ANALYSIS OF THE PROJECT

4.8. ANALYSIS OF THE PROJECT

4.9. ANALYSIS OF THE PROJECT

4.10. ANALYSIS OF THE PROJECT

5. ANALYSIS OF THE PROJECT

5.1. ANALYSIS OF THE PROJECT

5.2. ANALYSIS OF THE PROJECT

5.3. ANALYSIS OF THE PROJECT

5.4. ANALYSIS OF THE PROJECT

5.5. ANALYSIS OF THE PROJECT

5.6. ANALYSIS OF THE PROJECT

5.7. ANALYSIS OF THE PROJECT

5.8. ANALYSIS OF THE PROJECT

5.9. ANALYSIS OF THE PROJECT

5.10. ANALYSIS OF THE PROJECT

6. ANALYSIS OF THE PROJECT

6.1. ANALYSIS OF THE PROJECT

6.2. ANALYSIS OF THE PROJECT

6.3. ANALYSIS OF THE PROJECT

6.4. ANALYSIS OF THE PROJECT

6.5. ANALYSIS OF THE PROJECT

6.6. ANALYSIS OF THE PROJECT

6.7. ANALYSIS OF THE PROJECT

6.8. ANALYSIS OF THE PROJECT

6.9. ANALYSIS OF THE PROJECT

6.10. ANALYSIS OF THE PROJECT

7. ANALYSIS OF THE PROJECT

7.1. ANALYSIS OF THE PROJECT

7.2. ANALYSIS OF THE PROJECT

7.3. ANALYSIS OF THE PROJECT

7.4. ANALYSIS OF THE PROJECT

7.5. ANALYSIS OF THE PROJECT

7.6. ANALYSIS OF THE PROJECT

7.7. ANALYSIS OF THE PROJECT

7.8. ANALYSIS OF THE PROJECT

7.9. ANALYSIS OF THE PROJECT

7.10. ANALYSIS OF THE PROJECT