

.....  
.81 μ.

A - B: 49.30
B - Γ: 16.16
Γ - Δ: 25.55
Δ - Ε: 30.07
Ε - Ζ: 18.99
Ζ - Η: 19.23
Η - Θ: 31.46
Θ - Ι: 27.28
Ι - Κ: 24.08
Κ - Λ: 14.08
Λ - Α: 50.62

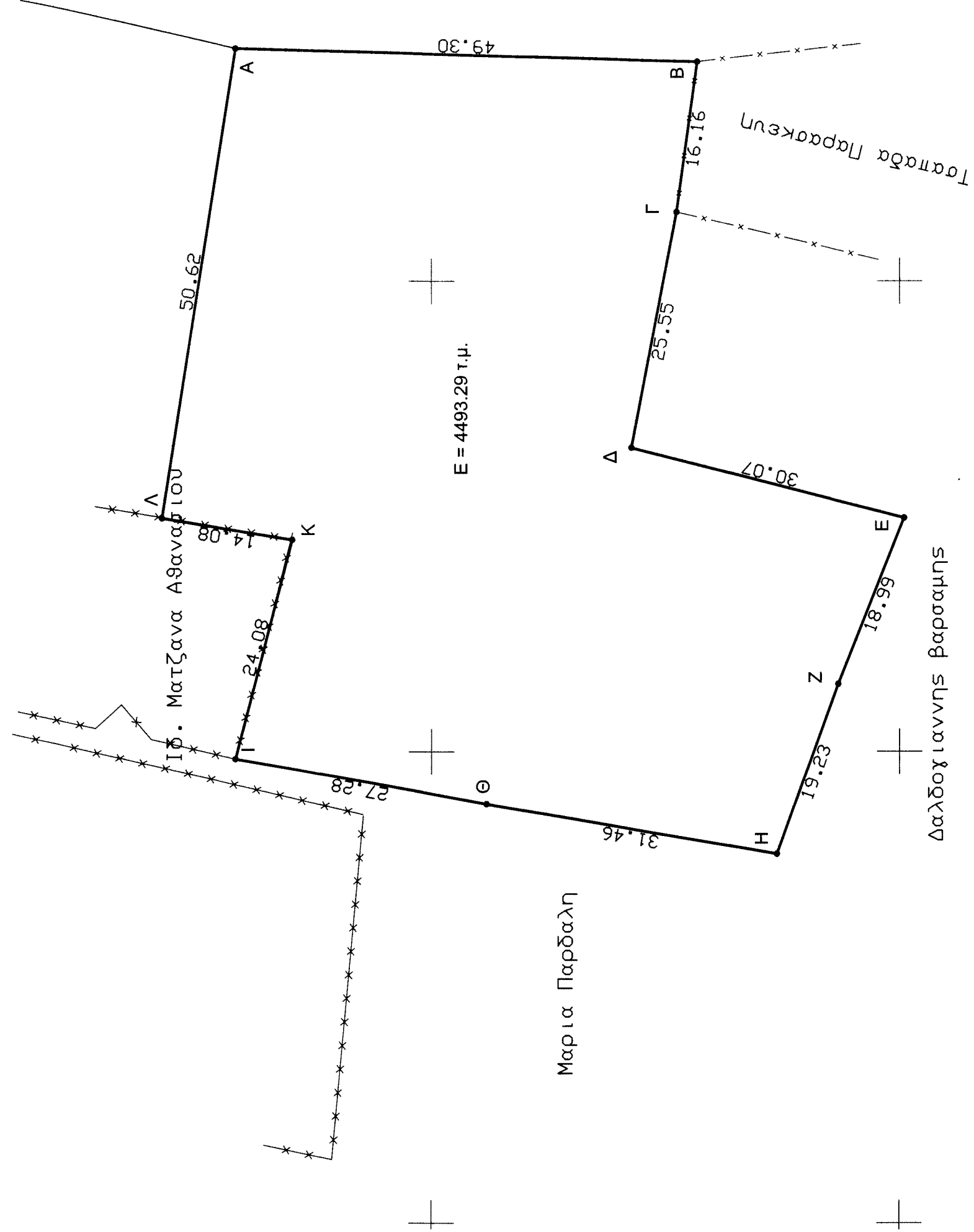

Ελένη Ξανθοπούλου  
Δασολόγος