

Handwritten notes in the top left corner, including a list of items and a table with columns for 'No.', 'Nama', and 'Keterangan'.

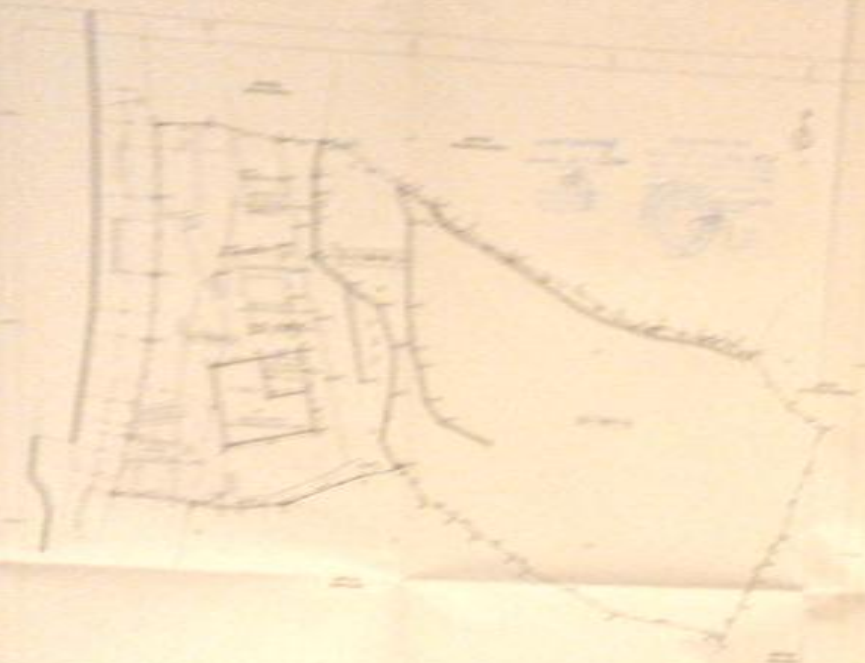

No.	Nama	Keterangan
1		
2		
3		
4		
5		
6		
7		
8		
9		
10		
11		
12		
13		
14		
15		
16		
17		
18		
19		
20		
21		
22		
23		
24		
25		
26		
27		
28		
29		
30		
31		
32		
33		
34		
35		
36		
37		
38		
39		
40		
41		
42		
43		
44		
45		
46		
47		
48		
49		
50		



Handwritten text in the middle section, including a title and several paragraphs of notes.

Handwritten text in the bottom middle section, including a title and several paragraphs of notes.



Handwritten text in the bottom right section, including a title and several paragraphs of notes.