

α/α	X (m)	Y (m)	S (m)
A	458504.72	-4577395.68	34.69
B	458524.62	-4577410.29	17.93
Γ	458534.31	-4577395.20	31.17
Δ	458558.30	-4577372.16	17.42
Ε	458568.65	-4577360.96	30.67
Ζ	458591.62	-4577340.64	17.52
Ζ	458596.82	-4577335.20	39.01
Θ	458569.82	-4577307.05	38.19
Ι	458539.56	-4577283.75	26.02
Κ	458515.71	-4577271.35	69.78
Λ	458483.19	-4577335.08	15.86
Μ	458486.97	-4577350.50	27.51
Ν	458479.19	-4577367.92	31.68
Α	458504.72	-4577395.68	
E = 8868.79τ.μ.			

α/α	X (m)	Y (m)	S (m)
A	458498.33	-4577306.54	89.00
B	458468.65	-4577360.96	30.67
Γ	458201.62	-4577310.64	7.82
Δ	458396.82	-4577335.70	39.01
Ε	458498.33	-4577307.05	38.19
Ζ	458396.82	-4577283.75	26.02
Η	458313.71	-4577306.34	37.52
Α	458498.33	-4577306.54	
E = 3997.21τ.μ.			

α/α	X (m)	Y (m)	S (m)
1	-5232.67	-123.97	24.70
2	-5212.84	-109.25	17.94
3	-5203.07	-124.30	31.18
4	-5181.96	-147.25	17.42
5	-5168.56	-158.38	30.68
6	-5145.47	-178.60	7.53
7	-5140.24	-184.01	39.02
8	-5167.12	-212.30	38.21
9	-5197.27	-235.76	26.03
10	-5221.08	-246.29	69.80
11	-5253.91	-184.70	15.86
12	-5250.30	-169.25	27.52
13	-5258.12	-142.86	31.69
1	-5232.67	-123.97	
E = 8875.00τ.μ.			

α/α	X (m)	Y (m)	S (m)
A	-5238.73	-213.17	89.03
B	-5168.56	-158.38	30.68
Γ	-5145.47	-178.60	7.53
Δ	-5140.24	-184.01	39.02
Ε	-5167.12	-212.30	38.21
Ζ	-5197.27	-235.76	26.03
Η	-5221.08	-246.29	69.80
Α	-5238.73	-213.17	37.53
E = 4000.00τ.μ.			

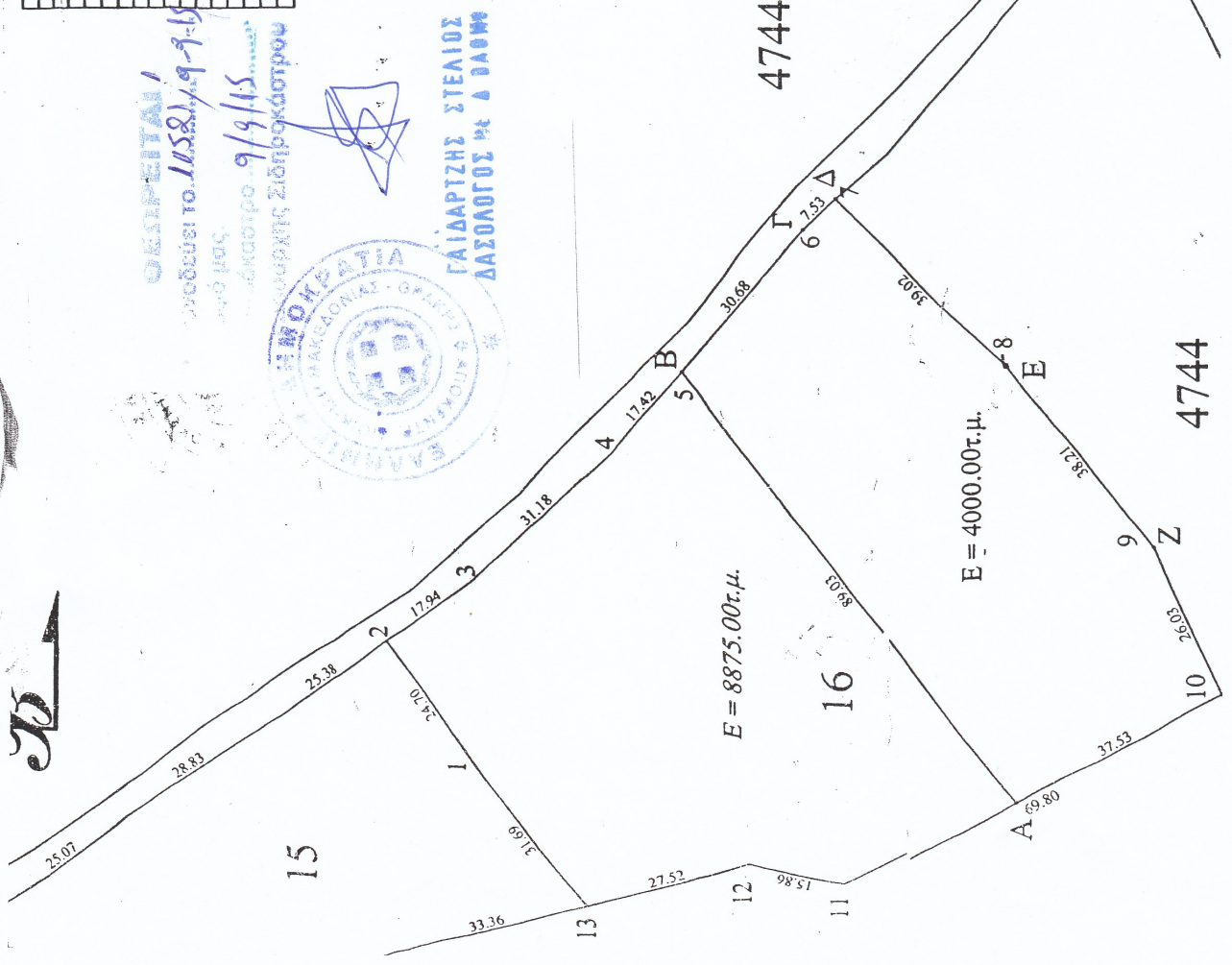

ΟΙΚΙΣΤΕΙΤΑΙ  
 Οριζώνεται το 1158/1.9-9-15  
 του 2015  
 με δικαστήριο 9/9/15.....  
 του Ελεγκτή Χαρτών  
 ΓΑΙΟΔΡΑΤΗΣ ΣΤΕΛΙΟΣ  
 ΔΑΣΟΛΟΓΟΣ με Δ. ΔΙΑΘΗ

