

ΠΙΝΑΚΑΣ ΣΥΝΟΛΙΚΩΝ ΚΟΡΥΦΩΝ ΙΔΙΟΚΤΗΣΙΑΣ
ΛΑΓΟΥ ΔΗΜΗΤΡΙΟΥ ΚΑΙ ΠΛΕΥΡΟΜΕΤΡΗΣΗΣ (ΕΓΓΡΑΦΗ)

ΚΟΡΥΦΗ	X	Y	ΑΓΙΟΤΑΞΙΑ
A1	266507.782	4331080.021	A1A2 = 6.03 m
A2	266509.781	4331094.833	A2A3 = 11.06 m
A3	266512.368	4331098.454	A3A4 = 9.34 m
A4	266511.418	4331104.790	A4A5 = 12.75 m
A5	266510.927	4331117.469	A5A6 = 14.91 m
A6	266510.087	4331132.367	A6A7 = 6.87 m
A7	266509.017	4331151.690	A7A8 = 11.53 m
A8	266503.868	4331147.981	A8A9 = 12.36 m
A9	266487.659	4331184.477	A9A10 = 18.96 m
A10	266486.184	4331171.548	A10A11 = 13.07 m
A11	266477.996	4331172.170	A11A12 = 20.00 m
A12	266467.320	4331168.909	A12A13 = 8.88 m
A13	266451.363	4331178.170	A13A14 = 12.20 m
A14	266440.988	4331181.548	A14A15 = 19.30 m
A15	266422.013	4331185.078	A15A16 = 10.49 m
A16	266412.283	4331207.583	A16A17 = 19.95 m
A17	266406.245	4331223.281	A17A18 = 17.37 m
A18	266398.778	4331233.798	A18A19 = 0.68 m
A19	266389.111	4331223.798	A19A20 = 12.92 m
A20	266380.770	4331213.834	A20A21 = 12.12 m
A21	266380.824	4331208.728	A21A22 = 12.12 m
A22	266380.128	4331207.704	A22A23 = 9.78 m
A23	266348.673	4331211.821	A23A24 = 11.86 m
A24	266339.783	4331221.128	A24A25 = 13.83 m
A25	266332.196	4331229.667	A25A26 = 11.65 m
A26	266326.036	4331235.833	A26A27 = 8.81 m
A27	266324.673	4331243.585	A27A28 = 4.71 m
A28	266323.376	4331248.109	A28A29 = 17.95 m
A29	266309.036	4331248.442	A29A30 = 14.88 m
A30	266291.436	4331248.784	A30A31 = 9.77 m
A31	266293.113	4331237.189	A31A32 = 10.89 m
A32	266292.162	4331226.307	A32A33 = 16.26 m
A33	266279.678	4331216.883	A33A34 = 32.12 m
A34	266268.848	4331188.741	A34A35 = 17.47 m
A35	266229.388	4331171.463	A35A36 = 47.49 m
A36	266231.005	4331129.178	A36A37 = 17.59 m
A37	266230.887	4331115.543	A37A38 = 20.99 m
A38	266234.703	4331100.857	A38A39 = 25.44 m
A39	266247.077	4331088.938	A39A40 = 13.20 m
A40	266245.737	4331101.688	A40A41 = 9.91 m
A41	266253.199	4331108.289	A41A42 = 9.91 m
A42	266254.883	4331103.039	A42A43 = 11.88 m
A43	266270.181	4331110.233	A43A44 = 15.48 m
A44	266238.613	4331138.544	A44A45 = 24.82 m
A45	266239.228	4331153.834	A45A46 = 21.48 m
A46	266230.513	4331178.723	A46A47 = 17.38 m
A47	266230.228	4331177.149	A47A48 = 9.43 m
A48	266237.590	4331178.998	A48A49 = 7.33 m
A49	266403.379	4331183.032	A49A50 = 5.43 m
A50	266413.128	4331183.418	A50A51 = 22.71 m
A51	266416.851	4331146.176	A51A52 = 17.87 m
A52	266430.233	4331130.998	A52A53 = 19.47 m
A53	266448.346	4331119.148	A53A54 = 24.21 m
A54	266488.591	4331108.872	A54A55 = 9.98 m
A55	266473.004	4331096.963	A55A56 = 6.88 m
A56	266475.449	4331088.909	A56A57 = 9.98 m
A57	266484.164	4331086.114	A57A58 = 10.59 m
A58	266495.142	4331085.544	A58A59 = 5.41 m
A59	266502.152	4331083.564	A59A60 = 1.43 m
A60	266501.659	4331083.181	A60A61 = 3.97 m
A61	266504.689	4331081.270	A61A62 = 3.97 m
A1	266507.782	4331080.021	A1A11 = 3.41 m

ΕΜΒΛΑΔΟ = 17.786,76 μ², ΠΕΡΙΜΕΤΡΟΣ = 846,16 μ

ΔΑΣΙΚΗ ΕΚΤΑΣΗ

ΔΑΣΙΚΗ ΕΚΤΑΣΗ

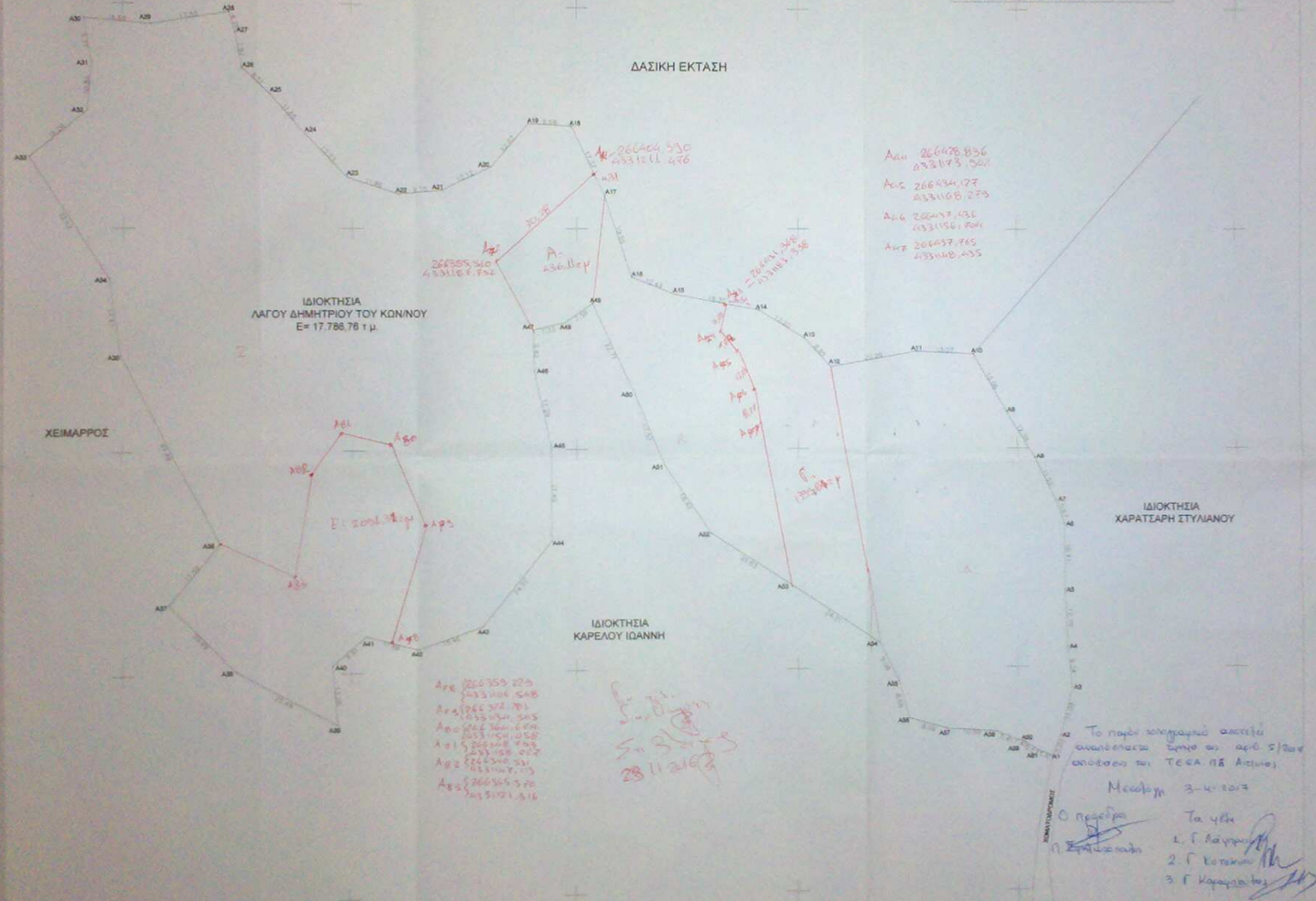

ΑΓΙΟΤΑΞΙΑ Φ.Χ. Γ.Υ.Σ. κλίμακα 1:50.000 ΠΑΥΤΟΝΟΥΣ



ΌΡΟΣ ΔΟΜΗΣΗΣ ΕΚΤΟΣ ΕΣΧΑΡΟΥ
Π.Α. 2431-5-1986Φ.Ε.Κ. 2793

ΚΑΤΑ ΚΑΜΟΝΑ
ΕΜΒΛΑΔΟΝ 4990 μ²

ΕΜΒΛΑΔΟΝ ΠΡΩΤΕΥΟΥ Ε = 17.786,76 μ²

(Α1, Α2, Α3, Α4, Α5, Α6, Α7, Α8, Α9, Α10, Α11, Α12, Α13, Α14, Α15, Α16, Α17, Α18, Α19, Α20, Α21, Α22, Α23, Α24, Α25, Α26, Α27, Α28, Α29, Α30, Α31, Α32, Α33, Α34, Α35, Α36, Α37, Α38, Α39, Α40, Α41, Α42, Α43, Α44, Α45, Α46, Α47, Α48, Α49, Α50, Α51, Α52, Α53, Α54, Α55, Α56, Α57, Α58, Α59, Α60, Α61, Α62)

ΔΙΑΣΤΑΣΗ ΥΠΟΚΟΝΙΣΜΕΝΩΝ ΟΡΙΩΝ
Ο υποκωνισμένος ύψους 3,40 μ, μήκους 10,59 μ, καταλαμβάνει τον χώρο που περιγράφεται από τις γραμμές Α1, Α2, Α3, Α4, Α5, Α6, Α7, Α8, Α9, Α10, Α11, Α12, Α13, Α14, Α15, Α16, Α17, Α18, Α19, Α20, Α21, Α22, Α23, Α24, Α25, Α26, Α27, Α28, Α29, Α30, Α31, Α32, Α33, Α34, Α35, Α36, Α37, Α38, Α39, Α40, Α41, Α42, Α43, Α44, Α45, Α46, Α47, Α48, Α49, Α50, Α51, Α52, Α53, Α54, Α55, Α56, Α57, Α58, Α59, Α60, Α61, Α62. Ο χώρος αυτός περιλαμβάνει τον χώρο που περιγράφεται από τις γραμμές Α1, Α2, Α3, Α4, Α5, Α6, Α7, Α8, Α9, Α10, Α11, Α12, Α13, Α14, Α15, Α16, Α17, Α18, Α19, Α20, Α21, Α22, Α23, Α24, Α25, Α26, Α27, Α28, Α29, Α30, Α31, Α32, Α33, Α34, Α35, Α36, Α37, Α38, Α39, Α40, Α41, Α42, Α43, Α44, Α45, Α46, Α47, Α48, Α49, Α50, Α51, Α52, Α53, Α54, Α55, Α56, Α57, Α58, Α59, Α60, Α61, Α62.

ΔΙΑΣΤΑΣΗ ΜΕΚΑΝΩΝ
Ο υποκωνισμένος Μήκους 3,40 μ, Πλάτους 9,91 μ, καταλαμβάνει τον χώρο που περιγράφεται από τις γραμμές Α1, Α2, Α3, Α4, Α5, Α6, Α7, Α8, Α9, Α10, Α11, Α12, Α13, Α14, Α15, Α16, Α17, Α18, Α19, Α20, Α21, Α22, Α23, Α24, Α25, Α26, Α27, Α28, Α29, Α30, Α31, Α32, Α33, Α34, Α35, Α36, Α37, Α38, Α39, Α40, Α41, Α42, Α43, Α44, Α45, Α46, Α47, Α48, Α49, Α50, Α51, Α52, Α53, Α54, Α55, Α56, Α57, Α58, Α59, Α60, Α61, Α62. Ο χώρος αυτός περιλαμβάνει τον χώρο που περιγράφεται από τις γραμμές Α1, Α2, Α3, Α4, Α5, Α6, Α7, Α8, Α9, Α10, Α11, Α12, Α13, Α14, Α15, Α16, Α17, Α18, Α19, Α20, Α21, Α22, Α23, Α24, Α25, Α26, Α27, Α28, Α29, Α30, Α31, Α32, Α33, Α34, Α35, Α36, Α37, Α38, Α39, Α40, Α41, Α42, Α43, Α44, Α45, Α46, Α47, Α48, Α49, Α50, Α51, Α52, Α53, Α54, Α55, Α56, Α57, Α58, Α59, Α60, Α61, Α62.

ΑΡΕΣΑΝΔΡΟΣ ΒΑΤ ΜΑΡΑΝΟΣ
ΔΙΠΛ. ΠΟΛΙΤΙΚΩΣ ΜΗΧΑΝΙΚΟΣ Ε.Ε.Κ.
ΠΡΩΤΟΒΡΑΧΙΑ ΥΠΟΚΟΝΙΣΜΟΥ ΔΙ. ΟΡΓΑΝΟ
7001, 26110 2302 ΣΕΚ, 26479 4978
0691 136651700, 0691 4379000

Το παρόν καταρτάθηκε σύμφωνα με τις διατάξεις του άρθρου 5/18 του νόμου 2643/1998 (Φ.Ε.Κ. 2793) και της ΤΕΕΑ ΠΕ Αττικής.
Μεταξύ 3-4-2013
Ο αρχιτέκτονας
Ο μηχανικός
Τα γένη
1. Γ. Παπαδόπουλος
2. Γ. Καραγιάννης
3. Γ. Καραγιάννης