

ΕΜΒΛΑΔΟΝ ΓΕΩΤΕΜΑΧΙΟΥ : $E(A-B \dots -N-E-A) = 2.544,42 \text{ τ.μ.}$

Τμήμα εκτός ορίων οικισμού : $E(A-B \dots -N-E-A) = 443,77 \text{ τ.μ.}$
Τμήμα εκτός ορίων οικισμού : $E(A-B \dots -N-E-A) = 2.100,65 \text{ τ.μ.}$

ΠΑΡΑΤΗΡΗΣΕΙΣ:

1. Το διαγράμμα είναι ενταγμένο στο κρατικό σύστημα συντεταγμένων ΕΓΣΑ '87
2. Οι διαστάσεις και τα εμβαδά υπολογίσθηκαν αναλυτικά κατά τη συνάρτηση των κορυφών
3. Η εγγραφή στο το ΕΓΣΑ '87 πραγματοποιήθηκε με χρήση GPS με ταυτοποίηση του ιδιόμορφου οδομέτρου σταθμού SNA ΕΠΙΤΕΤ' της εταιρείας METRACSA
4. Η εγγραφή έγινε με τη μέθοδο των πολυγωνικών συντεταγμένων και χρησιμοποιήθηκε ο γεωμετρικός σταθμός Leica Total Station TS08
5. Τα όρια του γεωμετρικού υπαβλήθησαν από τον ιδιοκτήτη.

ΤΕΧΝΙΚΟ ΓΡΑΦΕΙΟ ΜΕΛΕΤΩΝ
στύριος πετροκόκκος & συνίτες

ΚΑΙΣΑΡΕΙΑΣ 37 ΝΕΑ ΣΜΥΡΝΗ - ΤΗΛ. 2109597914 - FAX 2104229265

ΕΠΙΧΕΙΡΗΣΗ
ΦΙΦΩΝΗΣ ΓΕΩΡΓΙΟΣ

ΕΡΓΟΔΟΤΗΣ
ΑΠΟΤΥΠΩΣΗ ΔΙΟΙΚΗΣΙΑΣ

ΣΗΜΕΙΟ
ΟΙΚΙΣΜΟΣ ΧΑΡΑΚΑ - ΘΕΣΗ "ΤΣΕΜΠΕΡΙΖΑ"
Δ.Ε. ΖΑΡΑΚΑ ΔΗΜΟΣ ΜΟΝΕΜΒΑΣΙΑΣ

Κλίμακα
1:100

Τύπος ορίου
Τ1

ΤΟΠΟΓΡΑΦΙΚΟ ΔΙΑΓΡΑΜΜΑ

Χρόνος έκδοσης: ΑΠΡΙΛΙΟΣ 2023

Υπογραφή

ΠΕΤΡΟΣ ΚΑΚΕΑΣ ΣΤΥΡΙΟΣ
ΚΑΙΣΑΡΕΙΑΣ 37, ΝΕΑ ΣΜΥΡΝΗ
ΤΗΛ. 2109597914 Fax 2104229265
e-mail: petros@stirios.gr

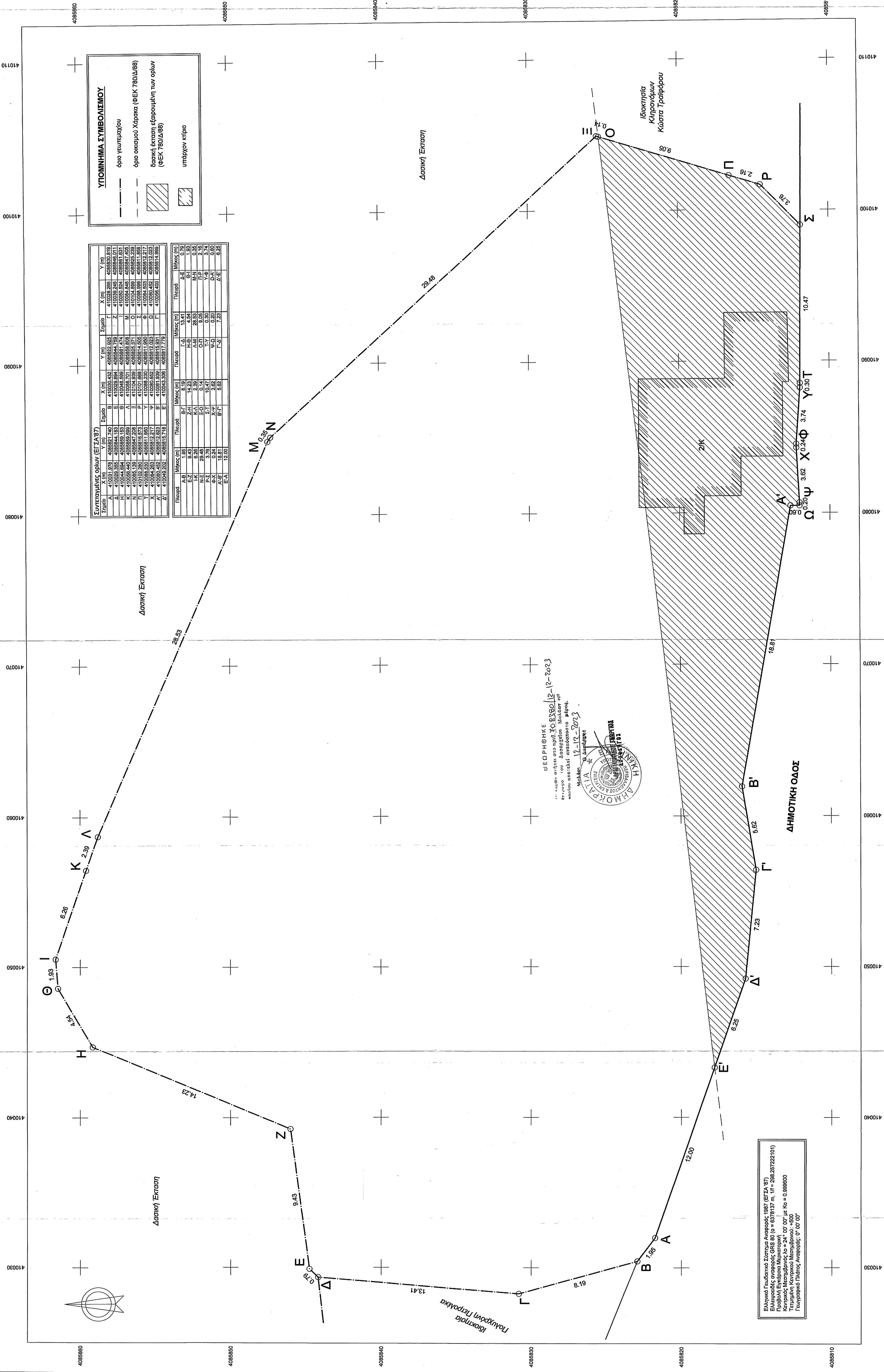

ΥΠΟΜΝΗΜΑ ΣΥΜΒΟΛΩΝ

- όριο γεωμετρικού
- - - όριο οικισμού Χάρακα (ΦΕΚ 780Δ/88)
- ▨ όρια οικισμού Χάρακα (ΦΕΚ 780Δ/88)
- ▩ υπόγειο κτίριο

Σταθμός	X (m)	Y (m)	Εμβαδόν	X (m)	Y (m)	Εμβαδόν	X (m)	Y (m)
A	410231.070	4098581.740	B	410029.432	4098242.563	F	410239.295	4098301.811
B	410029.432	4098242.563	C	410048.899	4098181.474	G	410050.624	4098181.474
C	410048.899	4098181.474	D	410050.624	4098181.474	H	410050.624	4098181.474
D	410050.624	4098181.474	E	410050.624	4098181.474	I	410050.624	4098181.474
E	410050.624	4098181.474	F	410050.624	4098181.474	J	410050.624	4098181.474
F	410050.624	4098181.474	G	410050.624	4098181.474	K	410050.624	4098181.474
G	410050.624	4098181.474	H	410050.624	4098181.474	L	410050.624	4098181.474
H	410050.624	4098181.474	I	410050.624	4098181.474	M	410050.624	4098181.474
I	410050.624	4098181.474	J	410050.624	4098181.474	N	410050.624	4098181.474
J	410050.624	4098181.474	K	410050.624	4098181.474	O	410050.624	4098181.474
K	410050.624	4098181.474	L	410050.624	4098181.474	P	410050.624	4098181.474
L	410050.624	4098181.474	M	410050.624	4098181.474	Q	410050.624	4098181.474
M	410050.624	4098181.474	N	410050.624	4098181.474	R	410050.624	4098181.474
N	410050.624	4098181.474	O	410050.624	4098181.474	S	410050.624	4098181.474
O	410050.624	4098181.474	P	410050.624	4098181.474	T	410050.624	4098181.474
P	410050.624	4098181.474	Q	410050.624	4098181.474	U	410050.624	4098181.474
Q	410050.624	4098181.474	R	410050.624	4098181.474	V	410050.624	4098181.474
R	410050.624	4098181.474	S	410050.624	4098181.474	W	410050.624	4098181.474
S	410050.624	4098181.474	T	410050.624	4098181.474	X	410050.624	4098181.474
T	410050.624	4098181.474	U	410050.624	4098181.474	Y	410050.624	4098181.474
U	410050.624	4098181.474	V	410050.624	4098181.474	Z	410050.624	4098181.474
V	410050.624	4098181.474	W	410050.624	4098181.474	A'	410050.624	4098181.474
W	410050.624	4098181.474	X	410050.624	4098181.474	B'	410050.624	4098181.474
X	410050.624	4098181.474	Y	410050.624	4098181.474	C'	410050.624	4098181.474
Y	410050.624	4098181.474	Z	410050.624	4098181.474	D'	410050.624	4098181.474
Z	410050.624	4098181.474	A'	410050.624	4098181.474	E'	410050.624	4098181.474
A'	410050.624	4098181.474	B'	410050.624	4098181.474	F'	410050.624	4098181.474
B'	410050.624	4098181.474	C'	410050.624	4098181.474	G'	410050.624	4098181.474
C'	410050.624	4098181.474	D'	410050.624	4098181.474	H'	410050.624	4098181.474
D'	410050.624	4098181.474	E'	410050.624	4098181.474	I'	410050.624	4098181.474
E'	410050.624	4098181.474	F'	410050.624	4098181.474	J'	410050.624	4098181.474
F'	410050.624	4098181.474	G'	410050.624	4098181.474	K'	410050.624	4098181.474
G'	410050.624	4098181.474	H'	410050.624	4098181.474	L'	410050.624	4098181.474
H'	410050.624	4098181.474	I'	410050.624	4098181.474	M'	410050.624	4098181.474
I'	410050.624	4098181.474	J'	410050.624	4098181.474	N'	410050.624	4098181.474
J'	410050.624	4098181.474	K'	410050.624	4098181.474	O'	410050.624	4098181.474
K'	410050.624	4098181.474	L'	410050.624	4098181.474	P'	410050.624	4098181.474
L'	410050.624	4098181.474	M'	410050.624	4098181.474	Q'	410050.624	4098181.474
M'	410050.624	4098181.474	N'	410050.624	4098181.474	R'	410050.624	4098181.474
N'	410050.624	4098181.474	O'	410050.624	4098181.474	S'	410050.624	4098181.474
O'	410050.624	4098181.474	P'	410050.624	4098181.474	T'	410050.624	4098181.474
P'	410050.624	4098181.474	Q'	410050.624	4098181.474	U'	410050.624	4098181.474
Q'	410050.624	4098181.474	R'	410050.624	4098181.474	V'	410050.624	4098181.474
R'	410050.624	4098181.474	S'	410050.624	4098181.474	W'	410050.624	4098181.474
S'	410050.624	4098181.474	T'	410050.624	4098181.474	X'	410050.624	4098181.474
T'	410050.624	4098181.474	U'	410050.624	4098181.474	Y'	410050.624	4098181.474
U'	410050.624	4098181.474	V'	410050.624	4098181.474	Z'	410050.624	4098181.474
V'	410050.624	4098181.474	W'	410050.624	4098181.474	A''	410050.624	4098181.474
W'	410050.624	4098181.474	X'	410050.624	4098181.474	B''	410050.624	4098181.474
X'	410050.624	4098181.474	Y'	410050.624	4098181.474	C''	410050.624	4098181.474
Y'	410050.624	4098181.474	Z'	410050.624	4098181.474	D''	410050.624	4098181.474
Z'	410050.624	4098181.474	A''	410050.624	4098181.474	E''	410050.624	4098181.474
A''	410050.624	4098181.474	B''	410050.624	4098181.474	F''	410050.624	4098181.474
B''	410050.624	4098181.474	C''	410050.624	4098181.474	G''	410050.624	4098181.474
C''	410050.624	4098181.474	D''	410050.624	4098181.474	H''	410050.624	4098181.474
D''	410050.624	4098181.474	E''	410050.624	4098181.474	I''	410050.624	4098181.474
E''	410050.624	4098181.474	F''	410050.624	4098181.474	J''	410050.624	4098181.474
F''	410050.624	4098181.474	G''	410050.624	4098181.474	K''	410050.624	4098181.474
G''	410050.624	4098181.474	H''	410050.624	4098181.474	L''	410050.624	4098181.474
H''	410050.624	4098181.474	I''	410050.624	4098181.474	M''	410050.624	4098181.474
I''	410050.624	4098181.474	J''	410050.624	4098181.474	N''	410050.624	4098181.474
J''	410050.624	4098181.474	K''	410050.624	4098181.474	O''	410050.624	4098181.474
K''	410050.624	4098181.474	L''	410050.624	4098181.474	P''	410050.624	4098181.474
L''	410050.624	4098181.474	M''	410050.624	4098181.474	Q''	410050.624	4098181.474
M''	410050.624	4098181.474	N''	410050.624	4098181.474	R''	410050.624	4098181.474
N''	410050.624	4098181.474	O''	410050.624	4098181.474	S''	410050.624	4098181.474
O''	410050.624	4098181.474	P''	410050.624	4098181.474	T''	410050.624	4098181.474
P''	410050.624	4098181.474	Q''	410050.624	4098181.474	U''	410050.624	4098181.474
Q''	410050.624	4098181.474	R''	410050.624	4098181.474	V''	410050.624	4098181.474
R''	410050.624	4098181.474	S''	410050.624	4098181.474	W''	410050.624	4098181.474
S''	410050.624	4098181.474	T''	410050.624	4098181.474	X''	410050.624	4098181.474
T''	410050.624	4098181.474	U''	410050.624	4098181.474	Y''	410050.624	4098181.474
U''	410050.624	4098181.474	V''	410050.624	4098181.474	Z''	410050.624	4098181.474
V''	410050.624	4098181.474	W''	410050.624	4098181.474	A'''	410050.624	4098181.474
W''	410050.624	4098181.474	X''	410050.624	4098181.474	B'''	410050.624	4098181.474
X''	410050.624	4098181.474	Y''	410050.624	4098181.474	C'''	410050.624	4098181.474
Y''	410050.624	4098181.474	Z''	410050.624	4098181.474	D'''	410050.624	4098181.474
Z''	410050.624	4098181.474	A'''	410050.624	4098181.474	E'''	410050.624	4098181.474
A'''	410050.624	4098181.474	B'''	410050.624	4098181.474	F'''	410050.624	4098181.474
B'''	410050.624	4098181.474	C'''	410050.624	4098181.474	G'''	410050.624	4098181.474
C'''	410050.624	4098181.474	D'''	410050.624	4098181.474	H'''	410050.624	4098181.474
D'''	410050.624	4098181.474	E'''	410050.624	4098181.474	I'''	410050.624	4098181.474
E'''	410050.624	4098181.474	F'''	410050.624	4098181.474	J'''	410050.624	4098181.474
F'''	410050.624	4098181.474	G'''	410050.624	4098181.474	K'''	410050.624	4098181.474
G'''	410050.624	4098181.474	H'''	410050.624	4098181.474	L'''	410050.624	4098181.474
H'''	410050.624	4098181.474	I'''	410050.624	4098181.474	M'''	410050.624	4098181.474
I'''	410050.624	4098181.474	J'''	410050.624	4098181.474	N'''	410050.624	4098181.474
J'''	410050.624	4098181.474	K'''	410050.624	4098181.474	O'''	410050.624	4098181.474
K'''	410050.624	4098181.474	L'''	410050.624	4098181.474	P'''	410050.624	4098181.474
L'''	410050.624	4098181.474	M'''	410050.624	4098181.474	Q'''	410050.624	4098181.474
M'''	410050.624	4098181.474	N'''	410050.624	4098181.474	R'''	410050.624	4098181.474
N'''	410050.624	4098181.474	O'''	410050.624	4098181.474	S'''	410050.624	4098181.474
O'''	410050.624	4098181.474	P					