

PROBATIONARY COURSE

DATE: \_\_\_\_\_

NO.	NAME	MARKS
1	ABHIRAM K. S.	78
2	ADARSH K. S.	75
3	ADITHYAN K. S.	72
4	ADITHYAN K. S.	70
5	ADITHYAN K. S.	68
6	ADITHYAN K. S.	65
7	ADITHYAN K. S.	62
8	ADITHYAN K. S.	60
9	ADITHYAN K. S.	58
10	ADITHYAN K. S.	55
11	ADITHYAN K. S.	52
12	ADITHYAN K. S.	50
13	ADITHYAN K. S.	48
14	ADITHYAN K. S.	45
15	ADITHYAN K. S.	42
16	ADITHYAN K. S.	40
17	ADITHYAN K. S.	38
18	ADITHYAN K. S.	35
19	ADITHYAN K. S.	32
20	ADITHYAN K. S.	30
21	ADITHYAN K. S.	28
22	ADITHYAN K. S.	25
23	ADITHYAN K. S.	22
24	ADITHYAN K. S.	20
25	ADITHYAN K. S.	18
26	ADITHYAN K. S.	15
27	ADITHYAN K. S.	12
28	ADITHYAN K. S.	10
29	ADITHYAN K. S.	8
30	ADITHYAN K. S.	5

FOR THE YEAR: 2010

BY: \_\_\_\_\_

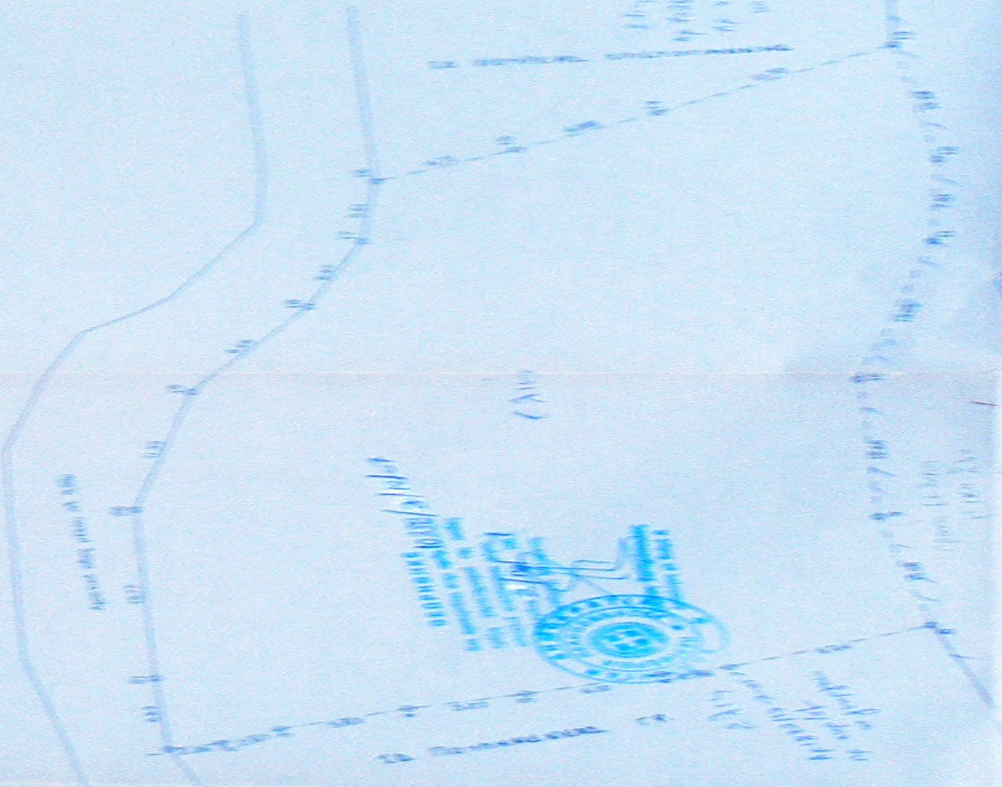

1. The first part of the course is to be completed by the student in the first semester. The student should complete the course in the first semester.

**OBJECTIVE**

The objective of this course is to provide the student with a comprehensive understanding of the subject matter. The student should be able to apply the knowledge gained in this course to solve real-world problems.

**SCOPE**

The scope of this course is to cover the following topics:   
 1. Introduction to the subject   
 2. Fundamentals of the subject   
 3. Applications of the subject   
 4. Advanced topics in the subject

**PREREQUISITES**

The student should have completed the following courses:   
 1. Mathematics   
 2. Science

**ASSESSMENT**

The student will be assessed through the following methods:   
 1. Written examinations   
 2. Practical work   
 3. Assignments   
 4. Projects

**REFERENCES**

The following references are recommended for this course:   
 1. Textbook on the subject   
 2. Journals and magazines   
 3. Websites   
 4. Other relevant materials

**APPENDIX**

The following information is provided for the student's reference:   
 1. Contact details of the course coordinator   
 2. Contact details of the department   
 3. Contact details of the institution

**APPENDIX**

The following information is provided for the student's reference:   
 1. Contact details of the course coordinator   
 2. Contact details of the department   
 3. Contact details of the institution

Page No. \_\_\_\_\_

Date: \_\_\_\_\_

Signature: \_\_\_\_\_

Department: \_\_\_\_\_

Institution: \_\_\_\_\_